

**Tools & Material Required**

- Allen key - 12mm
- Spanner - 29mm
- Adjustable Spanner

Key	Component	Qty
A	Manual Body (flow)	1
B	Manual Body (return)	1
C	Nut	2
D	Valve Tail (1/2" BSP)	2
E	Compression Fitting (15mm)	2

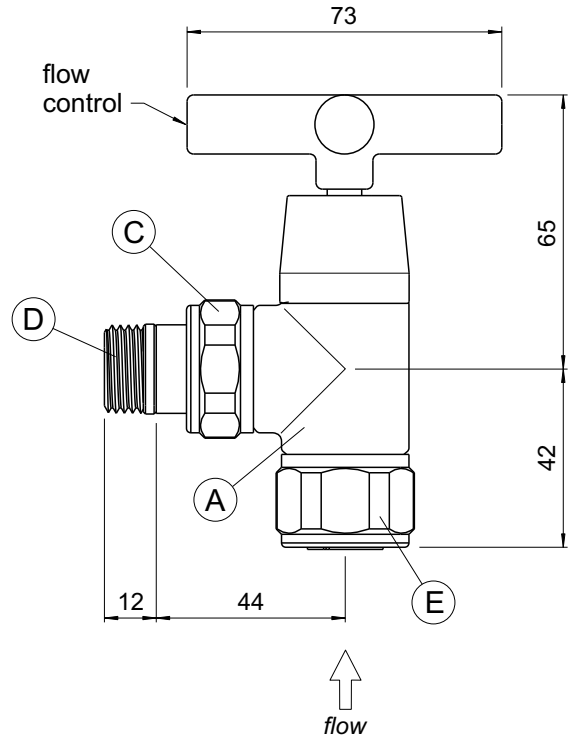
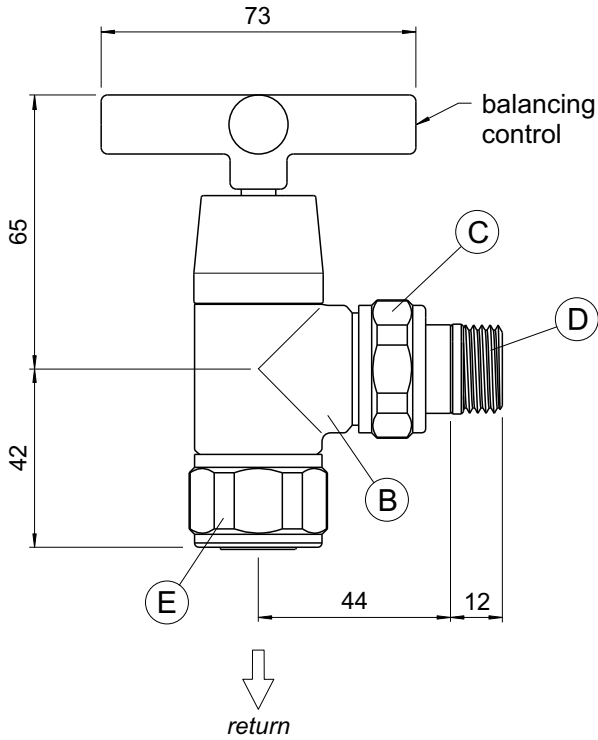

**Reverse Connections:**

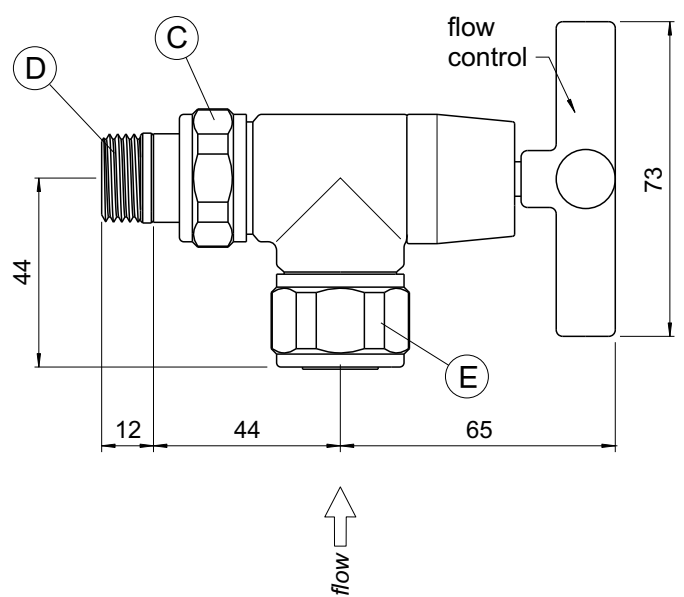
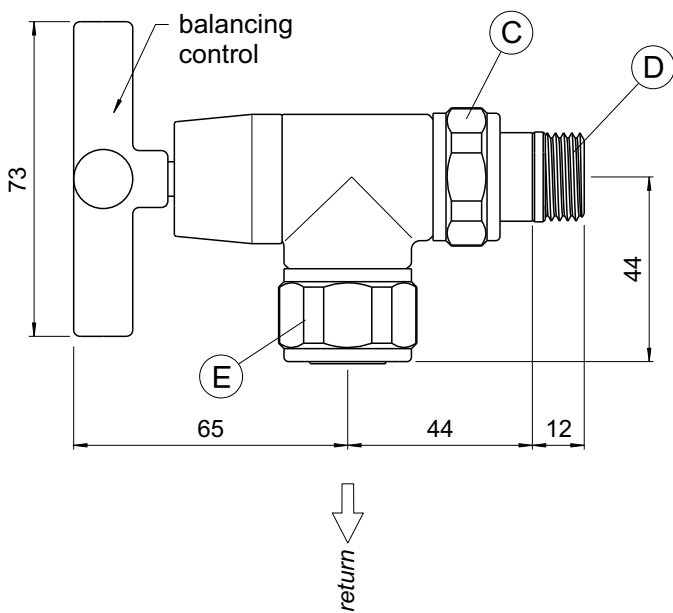

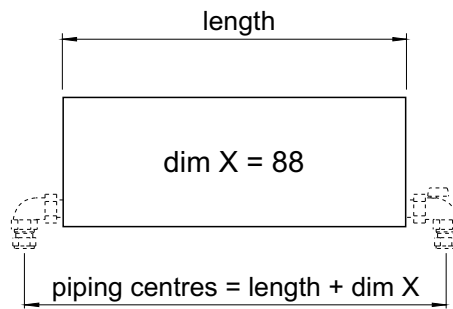

### Assembly Instructions

Fit valve tails (D) to radiator using 12mm Allen key, ensuring nut (C) is in place.

*Note: over-tightening of valve tails may cause damage to surface finish of radiator connections.*

*Do not use grips.*

Loosen compression fittings (E) and apply valve bodies (A) & (B) to 15mm pipe tails.

Install radiator onto bracket mountings and tighten valve tails (D) onto valve bodies (A) & (B).

Tighten compression fittings (E).

After filling and venting radiator, adjust balancing control to balance radiator.

For **reverse connections**, swap position of compression fitting (E) with nut (C) and valve tail (D).

Further technical information regarding valves (sheet TDS3.1) can be found on our website at [www.bisque.co.uk](http://www.bisque.co.uk) or by calling and requesting a faxed or posted copy on **01225 478500** (Bath) or **0207 328 2225** (London).