



# Quadrant Plus

## SHOWER ENCLOSURE INSTALLATION INSTRUCTIONS

Please read these fitting instructions before installation, as incorrect fitting will invalidate the guarantee

### Important! Please check that;

The shower base is the 'Quadrant-plus' shower tray. NB Do not attempt to fit this shower enclosure to any other type of tray.

There are no electrical cables or pipework behind the surface where drilling is required to fix the enclosure.

The wall to which the enclosure is to be fitted is reasonably flat and that the quadrant shower base is level and stable.

There are no visible defects. Claims for returns will not be accepted for visible defects found after installation.

Your guarantee is validated by attaching the identification label found on the unit and / or box, these details are essential when calling our technical department.

The screws and wall plugs provided are for use on masonry type walls. If the enclosure is to be fitted on another type of wall, e.g. Plasterboard, then appropriate fixings should be obtained.

### Product Dimensions

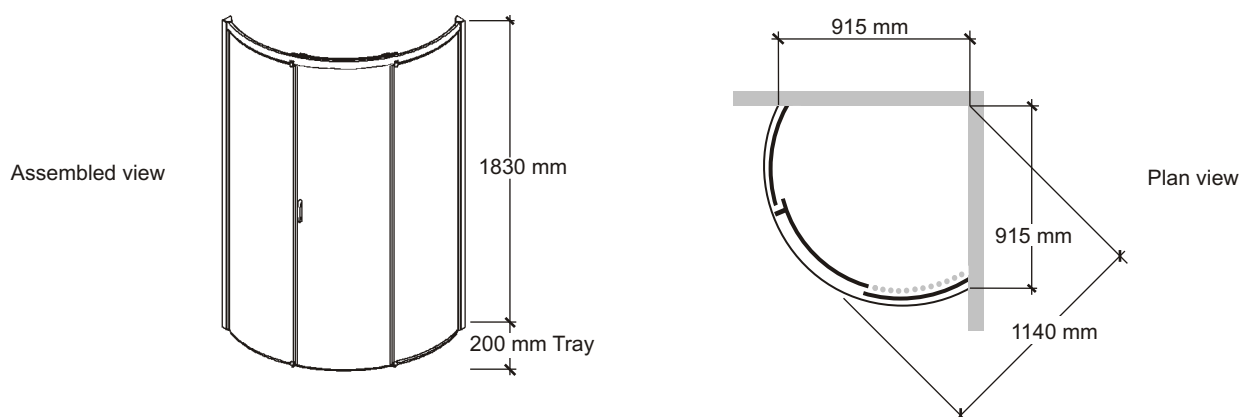

#### Tools required

Power drill  
Slotted screwdriver  
3mm drill bit

Posidrive screwdriver  
6mm masonry drill bit  
Spirit level

## Component Check List

- 1 Sliding door assembly (A)
- 2 Fixed panel assemblies (B1 left hand. B2 right hand)
- 2 Bottom pegs (C)
- 8 Wall plugs (D)
- 12 No 6 x 1 1/4" screws (E)
- 4 No 6 x 3/8" screws (F)
- 2 M4 x 30 csk' bolt (G)
- 2 Door stops (H)
- 1 Sliding door bottom seal (I)
- 2 Fixed panel bottom seal (J)
- 2 Fixed panel glass vertical seal (K1, K2)
- 1 Door glass vertical seal (K3)
- 2 Joint mouldings (L)
- 2 Wall channel end caps (M)
- 2 Wall channels (N)
- 2 Wall channel covers (O)
- 1 Top curved profile (P)
- 2 Clear handle 'inner' (R)
- 2 Handle 'outer' (S)
- 2 Handle screw caps (T)
- 2 No 6 x 1" screws (U)
- 2 No 6 x 5/8" screws (V)

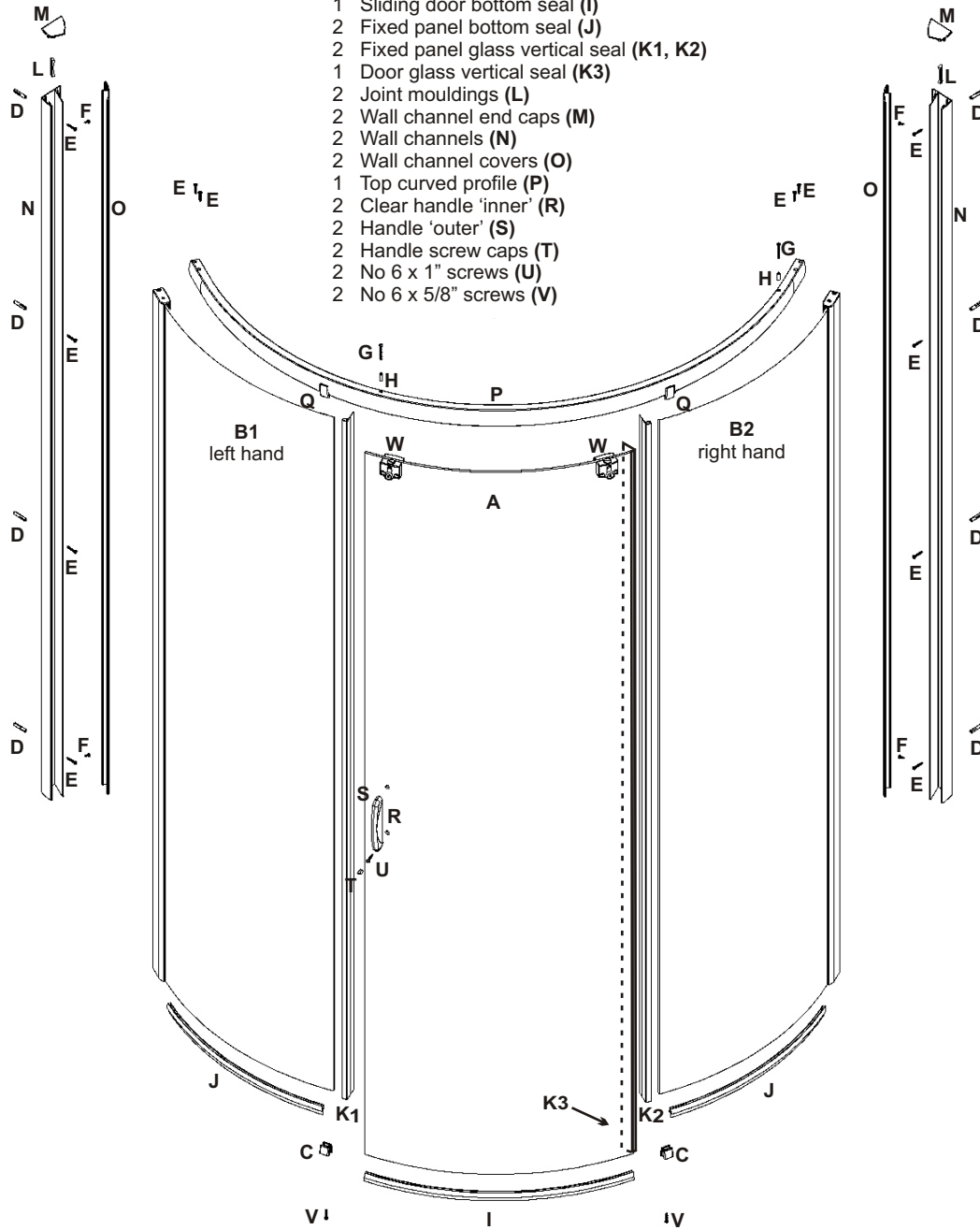

A non caustic based cleaning agent must be used when cleaning this product

## Fitting Instructions

### 1 Fit 'bottom peg'

It is advisable to fit the bottom peg to the tray before tray installation. Encircle each of the two holes on the lip of the tray with a small bead of silicone. Using the fixings provided 2 No 6 x 5/8" screws (V) secure the bottom pegs (C). Ensuring the angled bottom face of the pegs correspond with the angled lip of the shower tray (Diagram 1).

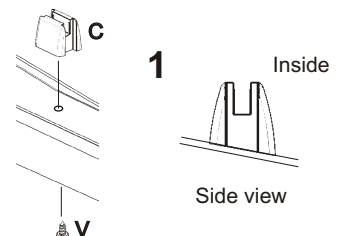

# 2

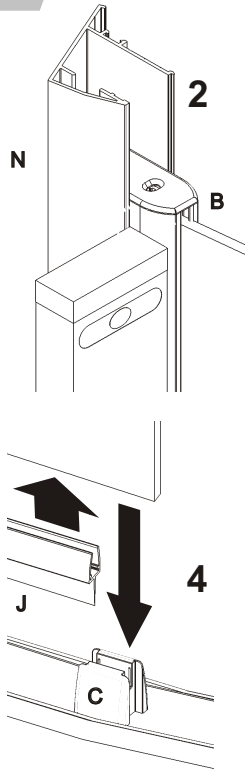

## Locate fixed side panels

Slide wall channel (N) onto the profile on the fixed panel (B) (Diagram 2).

Place profile of fixed panel (B) over the raised location feature on the tray, ensuring also that the glass locates into it's bottom peg (C) (Diagrams 3 & 4).

Using a spirit level check that the profile on the fixed panel is vertical (Diagram 2).

Slide the wall profile (N) to the wall and mark through the pre-drilled holes to indicate the position for drilling (Diagram 5), ensuring the profile of the fixed panel remains vertical.

Remove wall profile and fixed panel. Drill fixing holes using a 6mm masonry drill bit and insert the wall plugs (D). We recommend that suitable eye protection be worn when using power tools.

Run a bead of silicone sealant down the back of the wall channel, encircling the screw holes, then screw to the wall using 4 No 6 x 1 1/4" screws (E)

Fit the seal (J) to the bottom of the glass (Diagram 4). Re-position fixed panel into wall profile and bottom peg ensuring the end of the seal (J) touches the bottom peg (Diagram 4)

Carry out this procedure for both lefthand and right hand fixed side panels

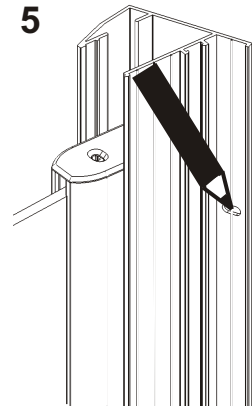
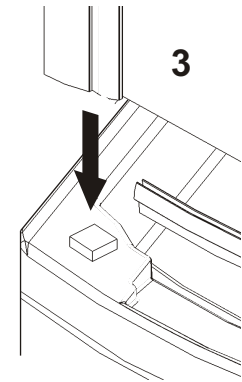

# 3

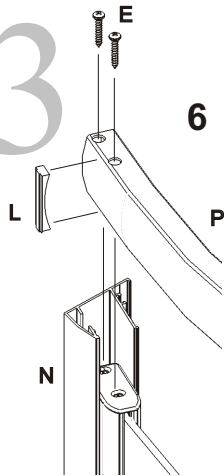

## Fitting of top curved profile

Carefully slide the top curved profile (P) into the top of the wall channels (N) During this procedure carefully insert joint mouldings (L) (with end lip facing downwards) between the outside face of the top curved profile and the insides of the wall channels (Diagram 6).

Screw the top curved profile to the profiles of the fixed panels using 4 No 6 x 1 1/4" screws (E) ensuring top pegs (Q) locate over glass (apply a small bead of silicone between glass and peg).

**IMPORTANT-** To assist with screw location use the screw retaining tube provided. Fit tube over screwdriver leaving minimum amount of tube protruding to slide over the head of the screw. NB; Use screwdriver with tube to 'start' screws only. Remove tube to tighten screws into position (Diagram 7)

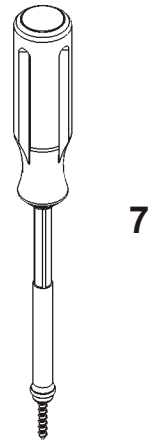

# 4

## Securing fixed side panels

Using a spirit level ensure that the two fixed panels (B) are vertical.

Minor adjustment can be made to the bottom of the fixed panels, ensuring a consistent door opening width.

Drill 4 holes from the inside of the enclosure through the wall channels into the fixed panel profiles using a 3mm drill bit (2 in each wall channel). Fasten into position using 4 No 6 x 3/8" screws (F) (Drill start positions indicated) (Diagram 8)

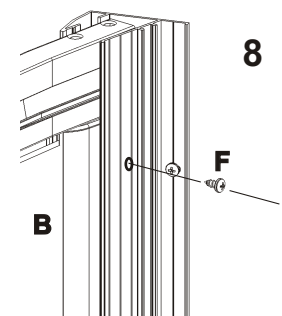

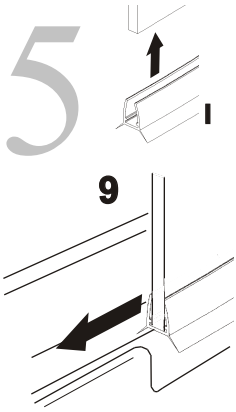

### Fitting sliding door

Prior to fitting sliding door (A), locate seal (I) to bottom edge (Diagram 9)

From the inside of the enclosure lift the door and slot the wheels at the top into the 2 recesses in the top curved profile (P) (Diagram 10) Carefully slide the door to the left ensuring that the seal on the bottom of the door locates into recess on the tray (Diagram 9)

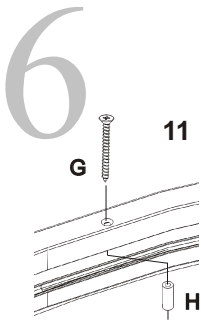
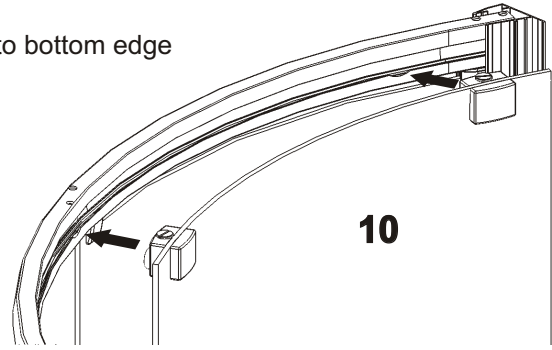

### Fitting door stops

Screw the 2 M4 x 30 csk' bolts (G) into the 2 countersink holes on the top of the top curved profile (P) inserting the door stops (H), during the process.(Diagram 11)

### Sliding door adjustment

To ensure the sliding door is vertical and to make any adjustment to the height of the door use a slotted screwdriver to adjust the screw located at the top of the 2 wheel blocks (W) to the top of the sliding door (Diagram 12)

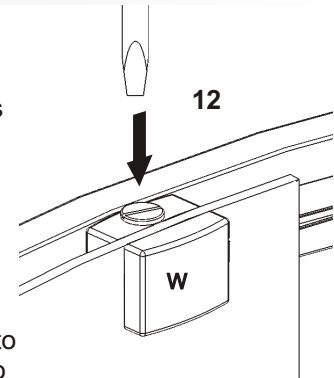

7

### Fitting Handle

Push into place the clear handle 'inners' (R) into the handle 'outers' (S) and locate onto holes in sliding door. Secure both sides together using 2 No 6 x 1" screws (U). Finish off by pressing into place the screw caps (T) (Diagram 13). Important; Use a small electrical screwdriver to carefully remove screw caps if the handle needs to be removed.

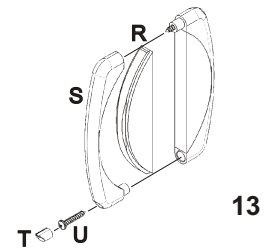

8

### Sealing

Apply a narrow bead of clear natural silicone sealant (not supplied) to the outside of the enclosure to areas:

- A; Bottom and sides of the wall channels.
- B; Bottom of the fixed panel profiles.
- C; Vertical joint between profile on fixed panel and wall channel to height of 20mm
- D; Bottom seal fixed panel/wall side gap between seal & edge of the tray.

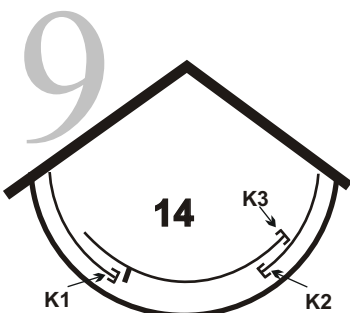

### Finishing off

Push on to the fixed door panels glass, the 3 vertical seals (K1 long flipper. - K2 1790mm. - K3 1835mm)) (Diagram 14).

Clip into place the 2 wall channel covers (O), and gently push into place the 2 clear end caps (M) at the top of the wall channels (Diagram 15).

