

Modern Art with AutoClose® has a minimalist and elegant design. Functional. Intelligent. The AutoClose® function makes the seat close automatically and ends the debate which has been going on for generations between the sexes.



Pressalit Modern Art with AutoClose®, soft close and quick-release, incl. D35 fixed hinge

No. 672xxx-D35xxx with cover
No. 672xxx-D34xxx with cover

Design/Year

Knud Holscher/Pressalit 2008

Product Description

PRESSALIT toilet seat with cover, model "Modern Art", art. no. 672 made of colour ingrained duroplast with stainless steel hinges with AutoClose®

- with D35 fixed hinge/D34 topmounted fixed hinge of stainless steel with soft close and quick-release
- removable seat/cover facilitates cleaning
- load - ring seat 240 kg
- suitable for many universal toilets
- soft, pleasant and well-balanced appearance with rounded edges
- 10 year guarantee (excluding electronic components, which are guaranteed for two years).

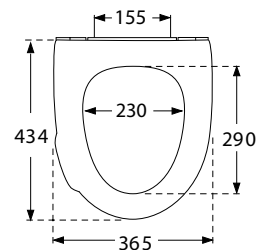

D35

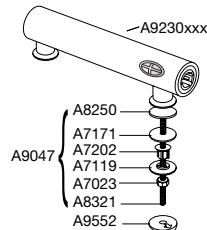

D34

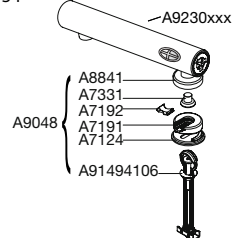

Colour Programme xxx

000 white, 001 black

Console xxx

000 white, 001 black

Hinge Finish

999 Stainless steel

Spare Parts

A4054 Buffer for pushing into cover, grey
A4001 Buffer for pushing into seat, oval, grey
A9047 Components for fixed hinge
A9048 Components for top mount.hinge
A6000P AutoClose® locking module
A9230000 Console tube AutoClose®, white
A9230001 Console tube AutoClose®, black

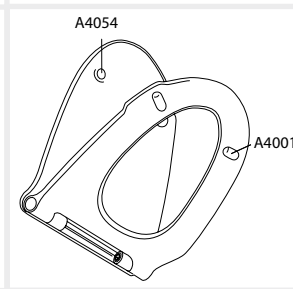
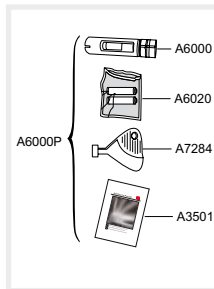

Seats for your senses

Product Weight

Net weight approx. 3,300 kg, incl. hinge

Packaging

Single carton
5 single cartons in a master carton
12 master cartons (60) per pallet

Dimensions:	Weight:
482x381x80 mm	3,600 kg
489x388x417 mm	18,700 kg

Material Description

TOILET SEAT:

The material is colour ingrained duroplast (UF A 10 = urea formaldehyde) that contains no environmentally hazardous substances. UF plastic comprises 67% urea formaldehyde resin, 28% cellulose, as well as 5% minerals, pigments, lubricants and moisture content.

The raw material from the supplier contains up to 0.03% free formaldehyde and even less following curing.

BUFFERS:

EVA (copolymer made of ethylene and vinyl acetate).

HINGES:

Stainless steel (V2A) model W. no. 1.4301/M in accordance with DIN 17441/85.
Plast/polyamid with 50% glasfiber.

AUTOCLOSE/QUICK-RELEASE COMPONENTS:

The mechanical parts are made of steel, thermoplastic and rubber.
In addition there is also a printed circuit board with components.

BATTERIES:

2 x AAA

Suitability List

Usable on universal toilets - see the printed seat suitability specifications.

Cleaning Instructions

Use a mild soap solution. Seat and hinges should not be left damp, but be dried with a soft cloth. When using abrasive, corrosive or chlorine based cleaners for the bowl, avoid contact with seat and hinges. Therefore, when cleaning the bowl, make sure that seat and cover are in an upright position until all the cleaner has been flushed away.

The guarantee includes faults or defects in the material of our products within a period of 10 years excluding electronic components, which are guaranteed for two years.

Products subject to minor technical modifications and design deviations E. & O.E.

