

Collage

Hinged Bath Screen

Instruction Manual



Truelife Consumer Guarantee

Please make sure the purchaser/end user completes and returns the Guarantee card which is enclosed with this product or registers on line at www.roman-showers.com/register_guarantee.htm. Failure to validate the Roman Truelife Guarantee will mean only the 1 Year Statutory Guarantee will apply.

PRODUCT CODE REF:

IMPORTANT

- Please ensure the consumer guarantee card enclosed with this product is completed and returned to Roman; please ensure the end user retains this manual.
- Please read these instructions carefully prior to attempting installation.
- Unpack and handle the product with care to avoid damage to the product finish.
- Check for hidden electrical cables and water pipes prior to commencing any drilling work.
- Ensure the walls where the Bath Screen is to be fitted are vertical. *Note: It is recommended that the walls are tiled after the Bath is fitted and grouted before fitting the Bath Screen. This will help provide maximum adjustment and will aid sealing.*
- No attempt should be made to rework toughened safety glass.
- Pictures used are for illustration purposes only; product designs may alter slightly as a result of continuing product development.
- The Hinged Bath Screen is designed for a shower head to be positioned **only** at the end of the bath - ensuring the spray is aimed down the full length of the Bath at all times.
- Roman over-bath products are not designed for use with Baths featuring shaped/stepped front or integral soap dishes.
- Suitable for all pumped systems/powershowers due to aluminium strip linking to bath.

Component Check List: Supplied

Ref	Description	Quantities
A	Wall Profile	1
B	Hinged Bath Screen	1
C	PVC Bottom Seal and Extrusion	1
D	Linking Strip	1
	Fitting Pack	
E	2.5mm Drill Bit	1
F	Wall Plugs (for brick or block wall)	3
G	40mm Screws	3
H	9mm Screws	3
I	Coloured Caps & Bases	3
J	Roman Branding Badge	1

Equipment Checklist: Not Supplied

Electric Drill
6mm Masonry Drill Bit
Bathroom Sealant Gun
Bathroom Sealant Tube
Screwdriver
Spirit Level
Tape Measure
Pencil
Wall Plugs (Plasterboard)

Before Assembly and Installation of the Hinged Bath Screen

- Check to see that you have the correct Bath Screen for your Bath. This can be done by referring to the label on the side of the product packaging.
- Ensure all parts are in the packaging by checking them against the parts and quantities shown on the component check list above.
- Check the product for defects. Installation queries on damaged parts can not be resolved once the installation has been completed.
- The Bath must be completely sealed along tiled walls, fitted level (check with a Spirit Level) and should have no leaks.

Notes: It is recommended that the Wall Profile be fitted directly onto tiles or a similar sealed surface. If walls or Bath or a combination of both are out of level you will not achieve full adjustment of maximum width. Roman do not stipulate where the British Standard Safety Kite Mark should be positioned on the glass panels when being factory assembled.



Figure A

- ① Ensure the Bath is completely level - check for any movement in the Bath by standing in it. Fill the Bath with water to check all plumbing for leaks.

Note: Please ensure the Bath is installed as per Manufacturer's Instructions.



Figure B

- ② Fill the Bath with water and fully seal the Bath along the tiled walls with a Bathroom Sealant (not supplied). Once the bath is fully sealed you must leave for at least 24 hours prior to commencing installation of the Hinged Bath Screen.

Note: Prior to commencing installation of the Bath Screen and once the sealant has cured, spray the shower handset around all joints to check for leaks.

Hinged Bath Screen

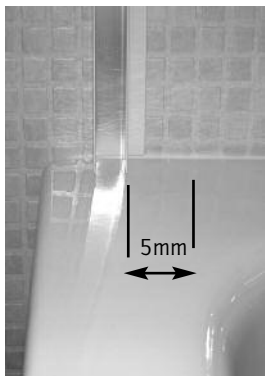

Figure a1



Figure a1i

- ① Decide which side of the Bath you want your Hinged Bath Screen to be positioned. Fit the inner edge of the Wall Profile (A) 5mm in from the inside edge of the Bath (**Figure a1**). Ensure the Wall Profile is completely vertical using a Spirit Level. Mark the holes with a pencil where the Wall Profile is to be positioned (**Figure a1i**).



Figure a2

- ② Drill the wall with a 6mm Masonry Drill Bit (not supplied) where the Wall Profile (A) is to be positioned. Fit the Wall Plugs (F) (if going into a brick or block wall). If going into a plasterboard wall you will need to purchase appropriate wall fixings. Wipe clear all debris before referring to the next stage.

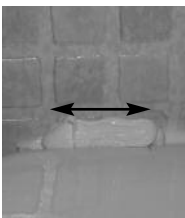

Figure a3

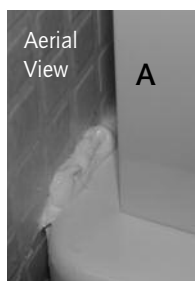

Figure a3i

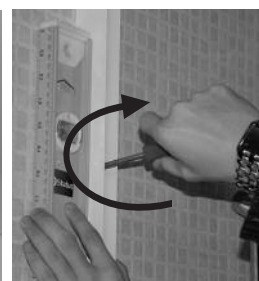

Figure a3ii

- ③ Where the Wall Profile (A) is to be positioned onto the Bath, place a bead of Bathroom Sealant (not supplied) the width of the Wall Profile along the tiled wall (**Figure a3/a3i**). Screw fix the Wall Profile to the wall using the 40mm Screws (G). Ensure the Wall Profile stays completely vertical throughout this procedure using a Spirit Level (**Figure a3ii**).

Note: No Bathroom Sealant should be present between the Wall Profile and the tiled wall vertically prior to screw fixing.



Figure a4

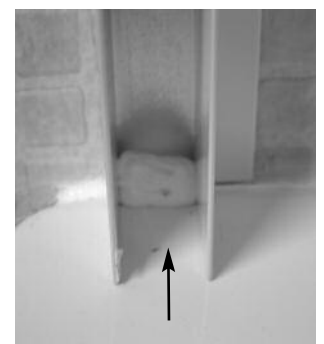

Figure a4i

- ④ Seal the gap between the Bath and the Wall Profile (A) with a Bathroom Sealant (not supplied) (**Figure a4/a4i**).

*Note: Failure to carry out this procedure correctly can result in serious water damage and is **not** covered by the 10-year manufacturer's guarantee.*

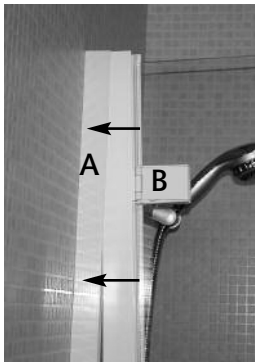

Figure a5

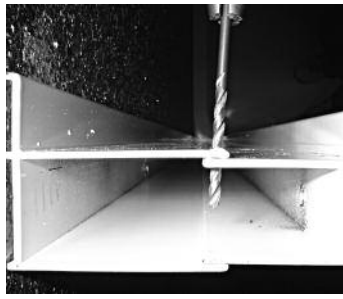

Figure a5i

⑤ Remove the cap from the bottom of the Hinged Bath Screen (B) and Slide the Hinged Bath Screen (B) inside the Wall Profile (A) (Figure A5). The Wall Profile must overlap the Hinged Bath Screen by at least 5mm (Figure a5i).

Note: The Hinged Bath Screen is an outward opening bath screen only.

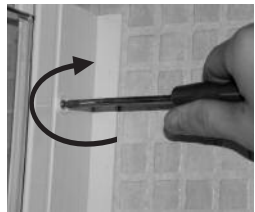

Figure a7



Figure a7i



Figure a7ii

⑦ Fix the 9mm Screws (H) into the Base Caps (I), then screw fix into the holes drilled in Stage 6 with a Screwdriver (Figure a7/a7i). Press fit the Cover Caps (I) into place over the Screw Base Caps once the Screws are fully tightened.



Figure a6

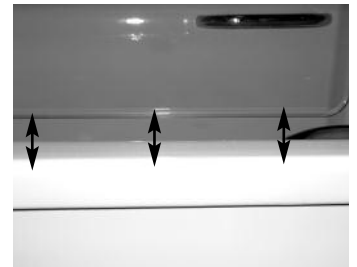

Figure a6i

⑥ Inside the bath, drill three holes into the Wall Profile (A) and the Hinged Bath Screen (B) with a 2.5mm Drill Bit (E). The 3 holes should be drilled 50mm from the top, 50mm approx. from the bottom and one in the centre (Figure A6). Ensure the gap between the bottom of the Hinged Bath Screen and the Bath Top is equal, if not further adjustment will be required (Figure A6i).



Figure a8

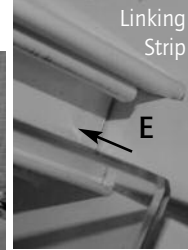

Figure a8i



Figure a8ii

⑧ Place a bead of Bathroom Sealant down the full length of the Linking Strip (D) (Figure 8). Slide the Linking Strip into the bottom of the vertical section of the Hinged Bath Screen (Figure 8i). Once the Linking Strip is pushed fully down onto the Bath top and parallel to the outside edge of the Bath, using a low adhesive tape secure the Linking Strip to the Bath top, the tape should be placed at both ends of the Linking Strip and one in the centre of the Linking Strip (Figure 8ii).

Note: Please ensure that the angled part of the Linking Strip is facing in towards the Bath.



Figure a9

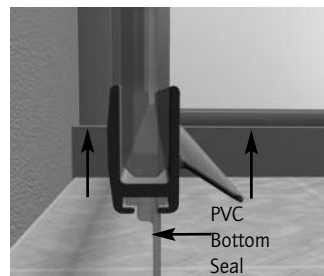

Figure a9i

⑨ Inside the groove of the Bottom Seal Extrusion (C), place a thin bead of Bathroom Sealant (not supplied) down both sides of the internal walls, the full length of the groove (Figure a9). Apply pressure to the Bottom Seal Extrusion onto the bottom of the glass Hinged Bath Screen (B). Hold the Bottom Seal Extrusion into place for a few minutes. (Figure a9i).

Note: Please ensure that the angled deflector strip is facing to the inside of the Bath enabling water to be deflected back into the Bath at all times.

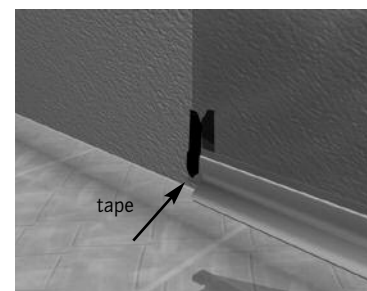

Figure a10

⑩ Using a low adhesive tape secure the Bottom Seal Extrusion (C) onto the glass and leave for a minimum of two hours. The tape should be placed at both ends and in the centre of the Bottom Seal Extrusion (Figure a10). This is to ensure that the Bottom Seal Extrusion does not move until the sealant has cured.



Figure a11



Figure a11i

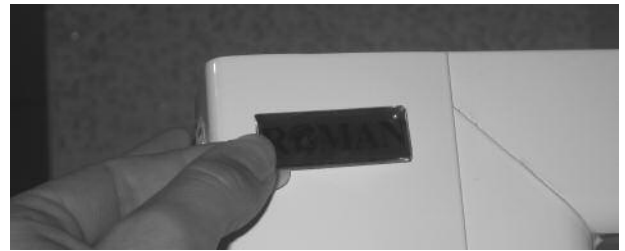

Figure a12

⑪ Once satisfied with installation of your Hinged Bath Screen (B), seal both sides of the Wall Profile (A) vertically inside and outside only where it meets the tiles (Figure a11/a11i). Fully seal the base of the Hinged Bath Screen along the Bath top from the outside only (Figure a11).

Note: please allow at least 24 hours for the sealant to cure prior to using your Hinged Bath Screen.

⑫ Ensure the Roman Branding Badge (J) is placed prominently on a non moving aluminium part.

Maintaining Your Enclosure

DO NOT use acidic based descaler products or products which are unsuitable for cleaning enamel surfaces, including abrasive cleaners or cleaners containing bleach or solvents, as these products will affect both the anodised and coated framework.

NEVER use scouring powder or pads or sharp instruments when cleaning the enclosure.

Roman Shower Enclosures and Bath Screens are designed for luxury showering and with care and attention you can keep them looking new for longer by using the strongly recommended **Roman Ultra Care**, the multi-purpose glass protector after cleaning (See back page). Alternatively, occasionally wipe your Roman Shower Enclosure with a mild detergent diluted with water and polish with a soft cloth. If you live in a hard water area, periodically clean with a 50/50 solution of white vinegar and soak for five minutes and remove any limescale residue by rinsing with warm water. Periodically clean the seals of your Enclosure with an anti-bacterial spray. This is all you require to keep the glass, seals and coated / anodised aluminium parts looking new.

If you have any problems with your Hinged Bath Screen once installed, please refer back to this Instruction Manual to ensure you have completed every stage correctly. In addition, a Trouble Shooter Guide has been provided in this Manual.

If you still experience any difficulties or have any queries please contact us on +44 (0) 1325 328034 for technical assistance.

Collage - Hinged Bath Screen Trouble Shooter Guide

Problem		Solution
Leaking	①	Check the gap between the Bath and the Wall Profile has been sealed correctly (Figure a4/a4i).
	②	Ensure the Bath is fully sealed along the tiled walls prior to installation (Figure B).
	③	If the Main Vertical Rail is sealed on the inside along the Bath top, this will cause leakage – the sealant must be removed.
	④	Ensure the Wall Profile on the tiled wall is sealed inside and outside where it meets the tiles only (Figure a11 /a11i).
	⑤	Ensure that the outside gap between the Hinged Bath Screen and Bath top is fully sealed (Figure a11).
	⑥	Is the Wall Profile fitted 5mm approx. from the inside edge of the Bath top (Figure a1/a1i)?
	⑦	Is the Bottom Seal slightly depressed onto the Linking Strip?
	⑧	Ensure the deflector strip on the Bottom Seal faces inwards towards the Bath (Figure a9i).
Hinged Bath Screen alignment on Bath	①	Is the Hinged Bath Screen fitted onto a tiled wall?
	②	Is the Wall Profile fitted 5mm approx. from the inside edge of the Bath top (Figure a1/a1i)?
	③	Is the Wall Profile completely vertical?

Other products available from Roman



Orbital Three in Bright Silver OQ313S/L with Clear Glass. Also available in White OQ313W. Shower Tray: 1150mm x 650mm Roman Tray RT031/R with integral tiling lip. Handing of enclosure and tray must be specified.

Unique is an over-used term these days. But not so when describing the Orbital Three. To begin with its 1150mm x 650mm size brings a new dimension in space optimisation whereby limited wall space is converted into maximum showering area. The expansive shape and massive door combine to create a showering enigma where space is fashioned as if from nowhere. Styled in 6mm curved glass, the shape of the Orbital Three brings a new and unusual showering solution.



Hinged Door with Unprinted Clear Glass and Bright Silver Frame - CL13S. Also, Shower Tray: 800 x 800mm - Colour - White - RA8S1.

The Roman Hinged Door uses 8mm thick glass to offer a sophisticated and contemporary outward opening option. When installed in a 3 wall aperture (as shown) the top rail of the frame can be removed to allow unrestricted height access - and the stunning edgework of this frameless Door becomes obvious. The Door closes onto twin ball catches for a solid closing action and is fully sealed for all showering systems. Four sizes are available - a 760mm/Neo-Angle option; 800mm; 900mm and 1000mm.



ULTRA CARE

THE MORE YOU SPRAY – THE MORE YOU PROTECT.

Roman Ultra Care is a product from Roman designed to give all your shower and bathroom surfaces a long-lasting sparkle. The benefit of Ultra Care is the more you spray, the more you protect.

Ultra Care is a multi-purpose glass protector that repels the build-up of grime, limescale and stains.

Roman Ultra Care was developed for Roman shower enclosures and screens. It is a unique and effective non-filming formula for all glass surfaces, tiles, shower seals and aluminium frames, taps, trays and baths.

Why not try it on your car windscreen!

For your nearest stockist please call +44 (0) 1325 328034

ROMAN LIMITED, WHITWORTH AVENUE, AYCLIFFE INDUSTRIAL PARK, COUNTY DURHAM, DL5 6YN, ENGLAND, UK.

Member of

GENERAL RECEPTION:	PHONE +44 (0) 1325 311318	FAX +44 (0) 1325 319889
CUSTOMER SERVICES:	PHONE +44 (0) 1325 328034	FAX +44 (0) 1325 328031
SALES ENQUIRIES:	PHONE +44 (0) 1325 328033	FAX +44 (0) 1325 328027



www.roman-showers.com