

ROMAN®

Freedom

Curved Panel

Instruction Manual



Truelife Consumer Guarantee

Please make sure the purchaser/end user completes and returns the Guarantee card which is enclosed with this product or registers on line at www.roman-showers.com/register_guarantee.htm. Failure to validate the Roman Truelife Guarantee will mean only the 1 Year Statutory Guarantee will apply.

PRODUCT CODE REF:

IMPORTANT PRE-INSTALLATION CHECKS

1. Check you have the correct enclosure. Please look at the labels on the side of the product packaging.
2. Check all the product components are in the box and the fixing kits are complete. Please check this with the component check list.
3. Un Pack your Roman product and handle it with care.
4. Please check the product for defects or damage. Once the installation has commenced Roman cannot accept responsibility for any defects or damage to the products.
5. Please take the time to read these instructions prior to installing your Roman Product.
6. Before you commence any drilling check there are no hidden electrical cables and/or water pipes in the walls.
7. No attempt should be made to re-work the toughened safety glass.
8. The installation should be performed by two persons.
9. It is strongly recommended the walls the Roman product is going to be installed on are vertical. However the Brace Bars have 35mm of adjustment to help compensate for some deviation.
10. It is strongly recommended the Roman product is fitted on tiled surface or similar waterproof surface.
11. It is strongly recommended the walls are tiled and grouted after the installation of the tray and before the installation of the Roman product. This will provide maximum adjustment and help when sealing the product.
12. If the walls and/or the tray are not level you will not achieve maximum adjustment of the product.
13. Pictures used are for illustration purposes only, product designs may alter slightly as a result of continuing product development.
14. Roman do not stipulate where the European Standard Kite Mark should be positioned on the glass panels when being factory assembled.

Component Check List: Supplied

Description	Quantity
Glass Linear Panel	1
Brace Bar Panel Cup	2
Brace Bar Wall Cup	2
Brace Bar	2
Fixing Kit - Component Check list.	
40 mm Screws	2
Wall Plugs	2
2.5mm Allen Key	1
3mm Allen Key	1
Branding Badge	1

Equipment Check List: Not Supplied

Description
Mains or Battery drill
6mm Masonry Drill Bit
Bathroom sealant gun
Bathroom sealant tube
Pozi Screw Driver
Spirit level
Tape measure
Pencil
Hacksaw
Additional fixings if going into plasterboard

INSTALLATION PROCEDURE

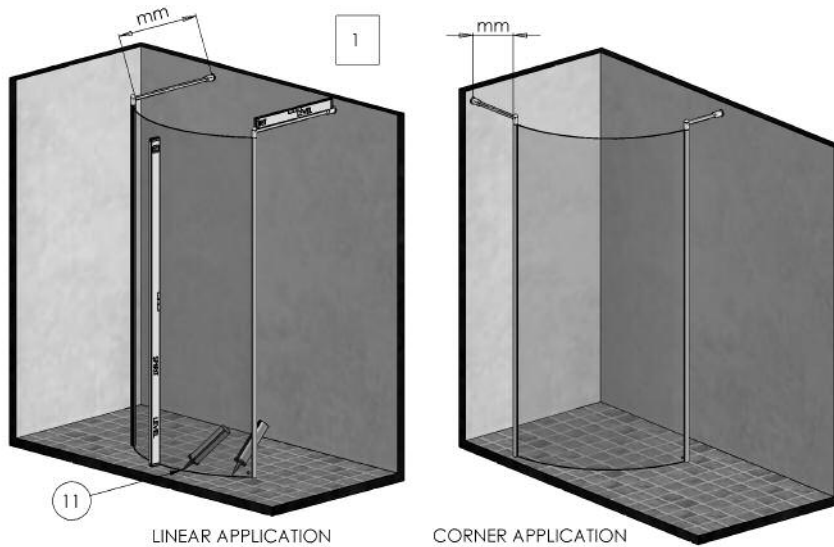

IMPORTANT: PLEASE ENSURE BRACING BARS ARE AT RIGHT ANGLES TO THE WALL

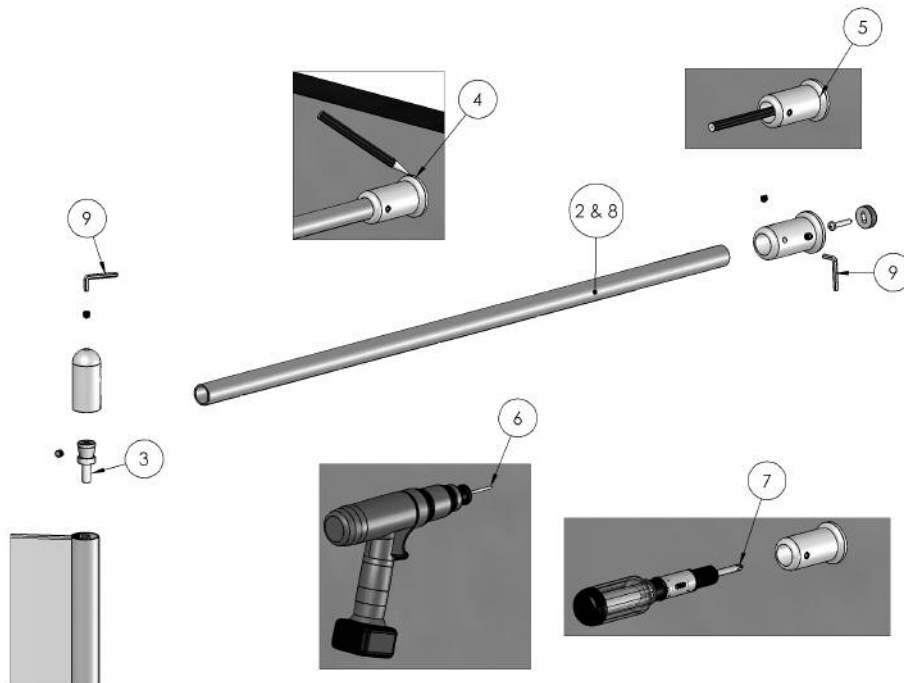

Choose to install the curved panel in a linear or corner style application:

1. Using a tape measure decide how far you would like the panel to be installed away from the wall
2. Using the measurement which was taken in line 1 cut the brace bars to the required length.
3. Using an Allen key disassemble the panel side location cup on one of the brace bars, screw the brass insert into the vertical side profile, then re-assemble the cup onto the brass insert. Do not tighten with an Allen key yet
4. Determine the location of the wall cup using the panel and full bracing assembly; mark the location with a pencil.
 - **Make sure the brace bar is completely level (the bubble is in the centre of the two lines of a spirit level)**
5. Position the wall cup concentric to the pencil mark and mark through the centre of the wall cup for the drill hole location.
6. Drill the location hole using a 6 mm masonry drill bit; insert the wall plug beyond the depth of the tile.
7. Screw-fix the wall cup onto the wall using the supplied 40mm screw.
8. Position the panel in the correct location by re-assembling the bracing bar onto the panel and into the wall cup.
9. Tighten all the grub screws in the wall and panel cups using the Allen keys when you are satisfied the brace bar has been adjusted correctly
10. Repeat 1-9 to fit the remaining brace bar
11. Seal the base of the linear panel to the wet-room floor (inside and outside), using a good quality bathroom sealant.
 - **You will require help to hold the panel in location during installation**
 - **There is 35mm adjustment in the brace bar to allow correct alignment**
 - **The brace bars must be level (the bubble should be in the centre of the two lines on the spirit level)**
 - **The curved panel must be vertically level (the bubble must be in the centre of the two lines on the spirit level)**



Spare Parts: If you require any spare parts, please look at the parts list below then call customer services on 01325 328034

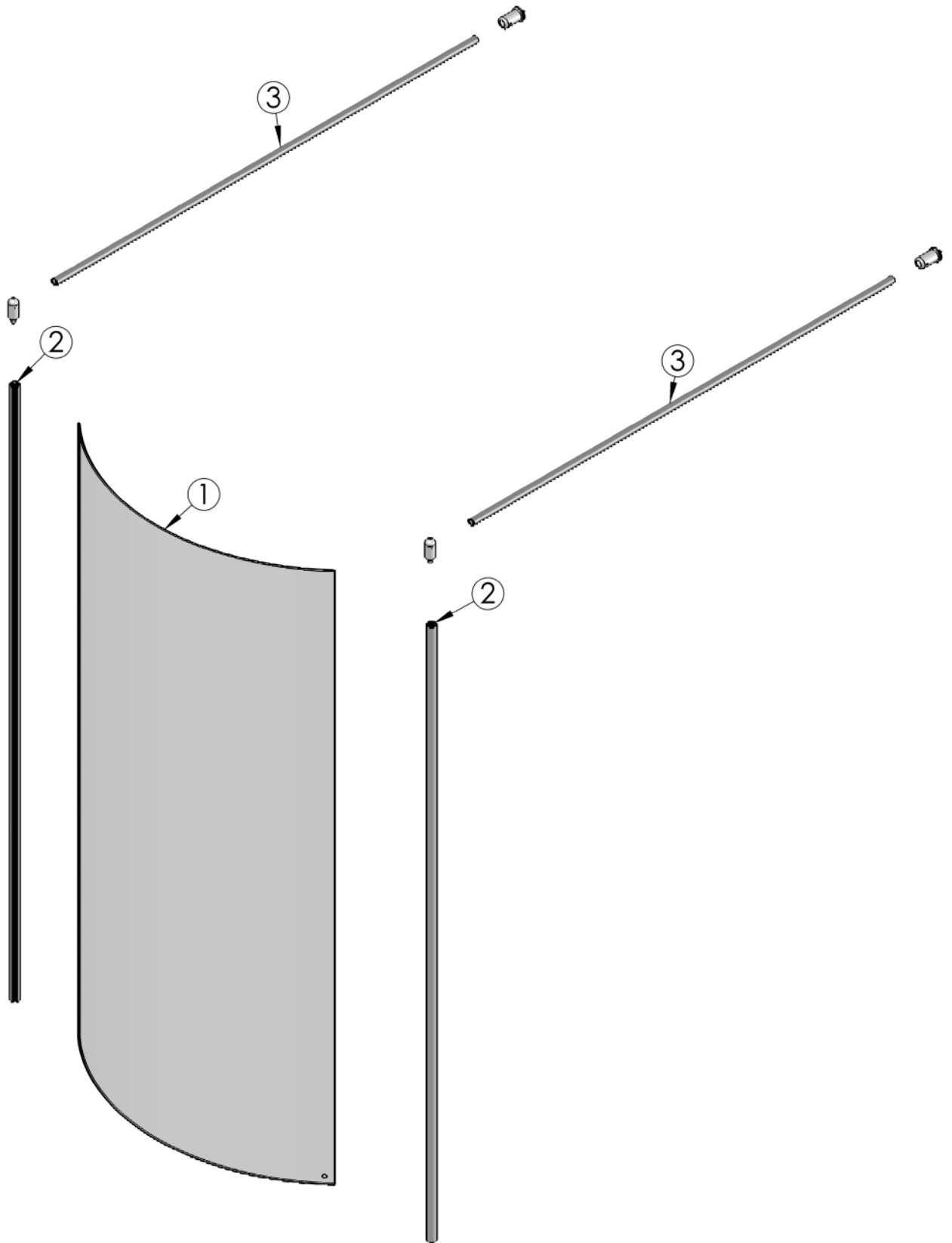

ITEM NO.	Part Number	Colour	Length (mm)	Description	Qty.
1	OF12	Clear		6mm Curved Fixed Panel Glass	1
2	ROF03S	Silver	1900	Circular Profile	2
3	RFBK01	Silver	1500	Brace Assembly	2

TROUBLE SHOOTING GUIDE.

Problem	Solution
LEAKING	1. Check the glass panel has been sealed correctly.
PANEL MOVING	1. Check the brace bars have been fitted correctly and all the grub screws and clamps have been sufficiently tightened. 2. Check the glass panel has been sealed correctly.

Some important information to help you Maintain your Roman product.

The following information is all you need to keep your Roman Product looking new.

Roman Showering Products are designed for luxury showering and with care and attention you can keep them looking new for longer by using the strongly recommended Roman Ultra care. This is a multi-purpose glass protector that is applied after cleaning.

Alternatively you can clean your Roman Product using a mild detergent diluted in water and then polished off using a soft cloth.

If you live in a hard water area, periodically clean your Roman product using a 50/50 solution of white vinegar and water. The solution should be left on the enclosure for approximately 5 minutes then rinsed off using warm water. This method of cleaning should remove lime scale residue.

Simple maintenance.

Roman Products are generally maintenance free, however it may be necessary to lubricate wheel assemblies and other moving parts from time to time. It is strongly recommended that a quality silicone spray is used.

A list of Don'ts:

- 1 - Don't use acidic based products which are unsuitable for cleaning enamel surfaces.
- 2 - Don't use Abrasive cleaners or cleaners containing bleach or solvents, these products will adversely affect the finish of the aluminium profiles.
- 3 - Don't use scouring pads, powder or any sharp instruments when cleaning the enclosure.



Ultra Care

THE MORE YOU SPRAY – THE MORE YOU PROTECT.

Roman Ultra Care is a product from Roman designed to give all your shower and bathroom surfaces a long-lasting sparkle. The benefit of Ultra Care is the more you spray, the more you protect.

Ultra Care is a multi-purpose glass protector that repels the build-up of grime, limescale and stains.

Roman Ultra Care was developed for Roman shower enclosures and screens. It is a unique and effective non-filming formula for all glass surfaces, tiles, shower seals and aluminium frames, taps, trays and baths.

Why not try it on your car windscreen!

For your nearest stockist please call +44 (0) 1325 328034

ROMAN LIMITED, WHITWORTH AVENUE, AYCLIFFE INDUSTRIAL PARK, COUNTY DURHAM, DL5 6YN, ENGLAND, UK.



GENERAL RECEPTION: PHONE +44 (0) 1325 311318 FAX +44 (0) 1325 319889
CUSTOMER SERVICES: PHONE +44 (0) 1325 328034 FAX +44 (0) 1325 328031
SALES ENQUIRIES: PHONE +44 (0) 1325 328033 FAX +44 (0) 1325 328027

www.roman-showers.com