

ROMAN®

Orbital

Bi-Fold Door

Instruction Manual



Truelife Consumer Guarantee

Please make sure the purchaser/end user completes and returns the Guarantee card which is enclosed with this product or registers on line at www.roman-showers.com/register_guarantee.htm. Failure to validate the Roman Truelife Guarantee will mean only the 1 Year Statutory Guarantee will apply.

PRODUCT CODE REF:

IMPORTANT PRE-INSTALLATION CHECKS

Some Important Information to read before you install your Roman Product.

- 1 **Very important** - This door can be installed in a right or left handed application, it has been manufactured right handed. To fit the door left handed, the hinge pins must be removed and re-inserted in the opposite end of the hinge, as shown in the diagram below. Failure to follow this procedure may result in the glass door dropping out of the frame.
If you are removing and re-inserting the hinge pins please perform this operation with the product laid down in the packaging.

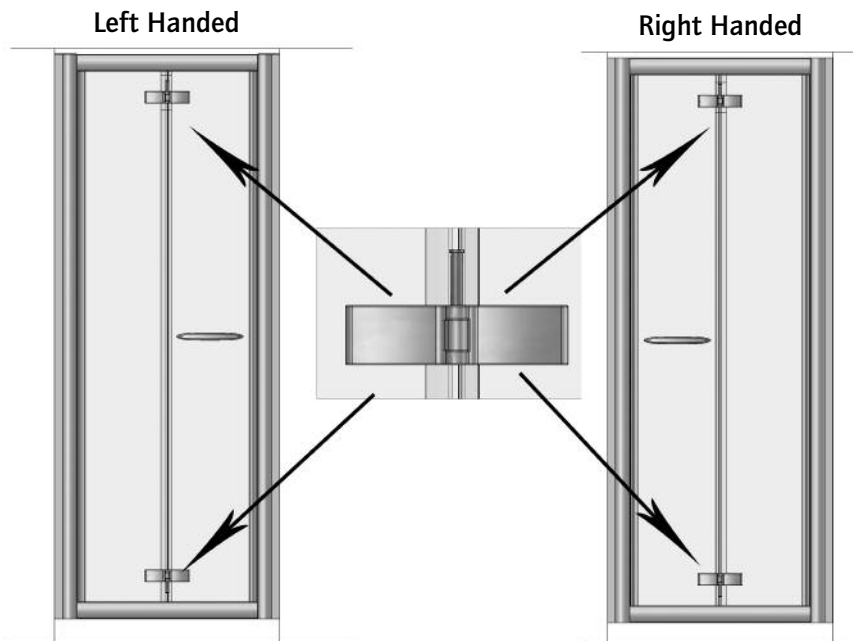

- 2 Check you have the correct enclosure and tray. Please look at the labels on the side of the product packaging.
- 3 Check all the product components are in the box and the fixing kits are complete. Please check this with the component check list inside.
- 4 Un Pack your Roman product and handle it with care.
- 5 Please check the product for defects or damage. Once the installation has commenced Roman cannot accept responsibility for any defects or damage to the products.
- 6 Please take the time to read these instructions prior to installing your Roman Product.
- 7 Before you commence any drilling check there are no hidden electrical cables and/or water pipes in the walls.
- 8 No attempt should be made to re-work the toughened safety glass.
- 9 The installation should be performed by two persons.
- 10 It is strongly recommended that the walls the Roman product is going to be installed on are vertical. However the wall profiles have 25mm of adjustment to help compensate for some deviation.
- 11 It is strongly recommended the Roman product is fitted on tiled surface or similar waterproof surface.
- 12 It is strongly recommended the walls are tiled and grouted after the installation of the tray and before the installation of the Roman product. This will provide maximum adjustment and help when sealing the product.
- 13 If the walls and/or the tray are not level you will not achieve maximum adjustment of the product.
- 14 Pictures used are for illustration purposes only, product designs may alter slightly as a result of continuing product development.
- 15 Roman do not stipulate where the European Standard Kite Mark should be positioned on the glass panels when being factory assembled.

Component Check List: Supplied

Description	Quantity
Wall profiles	2
Bi- Fold Door	1
Wall Profile Trims	2
Handle	1

Fixing Kit - Component Check list.

40 mm Screws	6
Wall Plugs	6
Profile Cover Caps	4
16 mm Screws	6
3mm Drill Bit	1
Roman Branding Badge	1

Equipment Check List: Not Supplied

Description

Mains or battery drill
6mm masonry drill bit
Bathroom sealant gun
Bathroom sealant tube
Pozi Screw driver
Spirit levels
Tape measure
Pencil
Additional fixings if going into plaster board

IMPORTANT PRE-INSTALLATION CHECKS

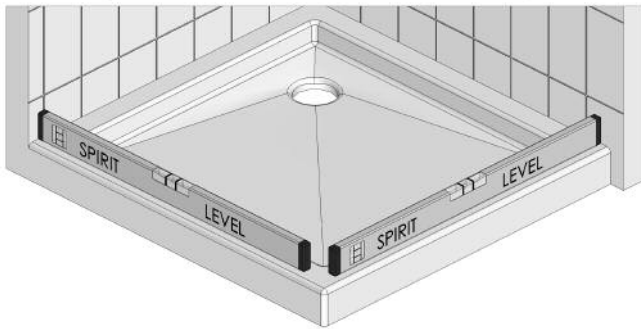

Step 1 - Checking the tray

Check the tray is completely level, by placing a spirit level on all four sides of the tray. The tray will only be completely level when the spirit level bubble is in the centre of the two lines, as shown.

Stand in the tray and check there is no adverse movement..

TIP: Always follow this procedure.

Step 2 - Checking the tray

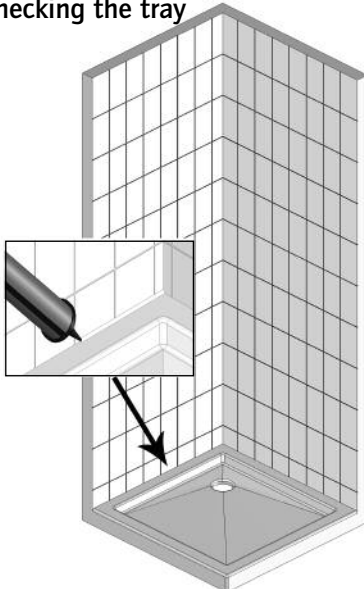

All tiling and grouting should be completed up to the tray.
The tiled wall and tray should be sealed using bathroom sealant (not supplied).

When tiling adhesive, grout and sealant has cured, spray the seal and all the joints with the shower head and check for any leaks.

Check the plumbing is water tight.

TIP: The tiling and grouting need to be completed prior to the installation of the enclosure because the grout will cause discolouration to the aluminium parts.

Step 3 - Checking the tray

If you are satisfied **Steps 1 - 3** are complete you are ready to proceed with the installation of your Roman enclosure.

If you are in any doubt regarding the tray installation, rectify any potential problems before fitting your Roman enclosure.

Please proceed to Step 4.

INSTALLATION INSTRUCTIONS

Step 4 - Fitting the 1st Wall Profile

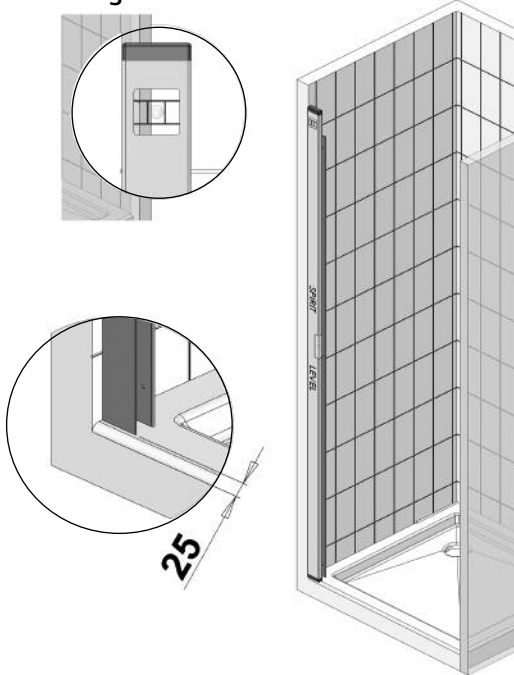

The wall profiles should be fitted 25mm from the front of the tray. The wall profiles need to be fitted completely vertical, this should be checked using a spirit level.

Only when the bubble of the spirit level is in the centre of the two lines are the wall profiles completely level.

TIP: Always follow this procedure.

Step 5 - Fitting the 1st Wall Profile

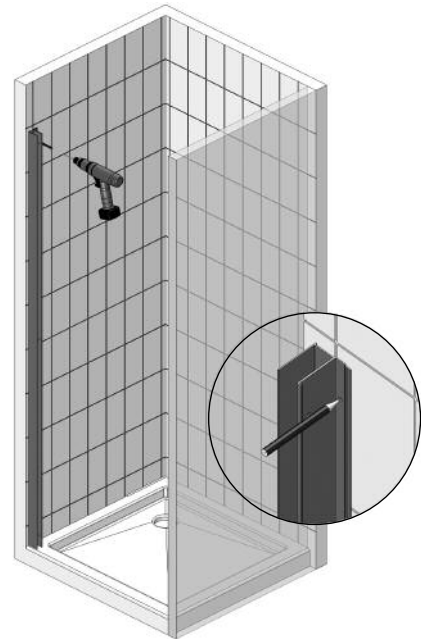

Mark the hole positions using a pencil.

Drill the wall with a 6 mm masonry drill bit (not supplied) in the locations previously marked using the pencil.

To fit profiles into brick or block work:

Fit the wall plugs into the holes in beyond the depth of the tile.

To fit profiles into plasterboard:

Appropriate plasterboard fittings will need to be used and not the supplied wall plugs.

Step 6 - Fitting the 1st Wall Profile

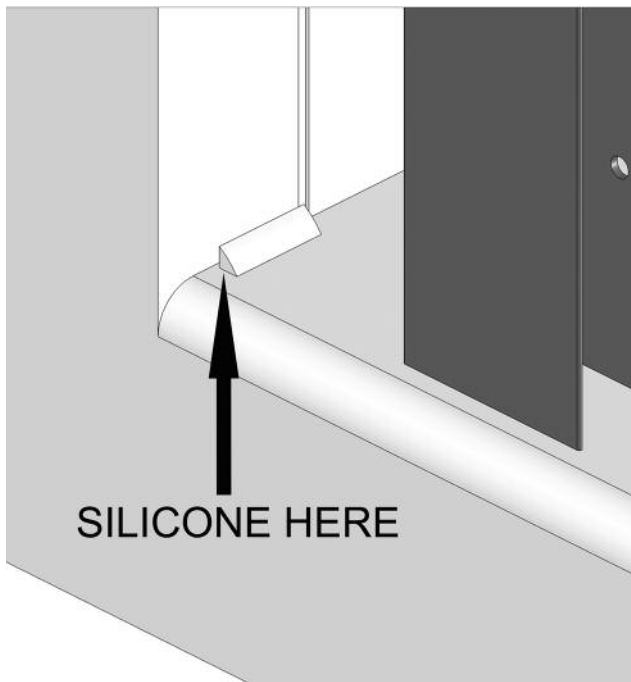

Apply a bead of silicone (not supplied) the width of the profile along the tiled wall and the tray; in the location where the wall profile is going to be fitted.

Failure to apply the silicone may cause serious water damage and is not covered by the guarantee. Have you applied it?

Step 7 - Fitting the 1st Wall Profile

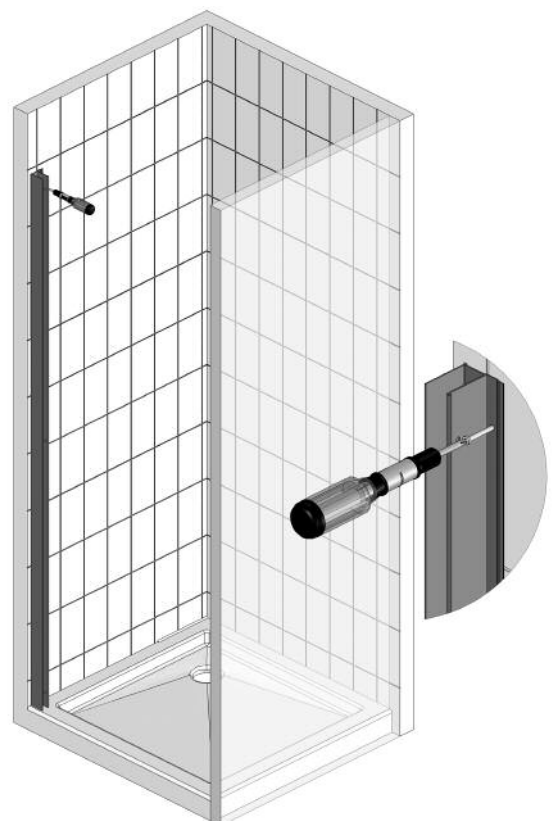

Fix the wall profile to the wall using supplied the 40mm screws.

Step 8 - Fitting the 1st Wall Profile

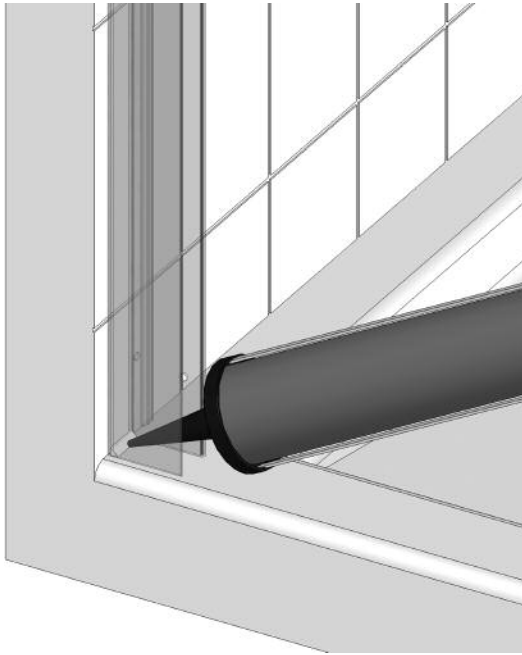

Now apply a bead of silicone inside the rear of the wall profile along the tile.

Failure to apply the silicone may cause serious water damage and is not covered by the guarantee. Have you applied it?

Step 9 - Lifting the door into position

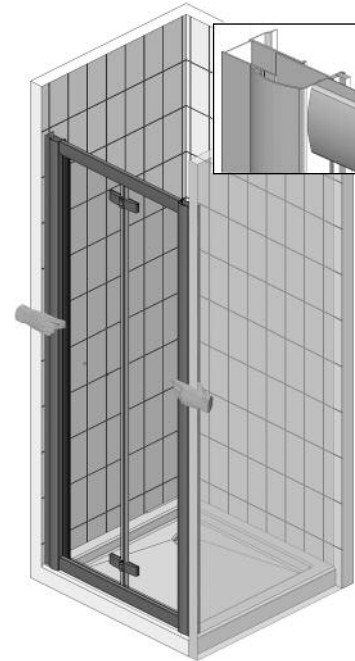

Slide the second wall profile onto the door frame and lift the door and attached profile onto the tray. Slide the door into the fitted wall profile.

Important: You may need help here to lift the door into location.

Important: Your door should be sitting completely level on the tray. If the door is not level here to not proceed and check the tray installation.

Step 10 - Fitting the 2nd Wall Profile

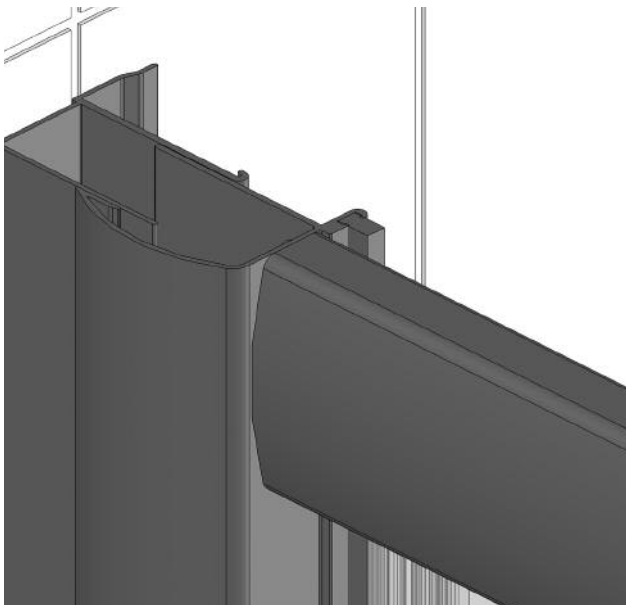

Repeat installation Steps 4 - 8 and fit the second wall profile.

If you are fixing the door with a panel, refer to Step 1 in your panel instructions when the 2nd wall profile is fitted.

If you are fitting the door to a 3 sided alcove please proceed to the next step when the 2nd wall profile is fitted.

TIP: When applying the silicone inside the profile (Step 8) you will need to push the door to the front of the profile channel in order to fit the nozzle of the silicone gun into the profile.

Important: You may need help here to hold the door.

Step 11 - Positioning the Door

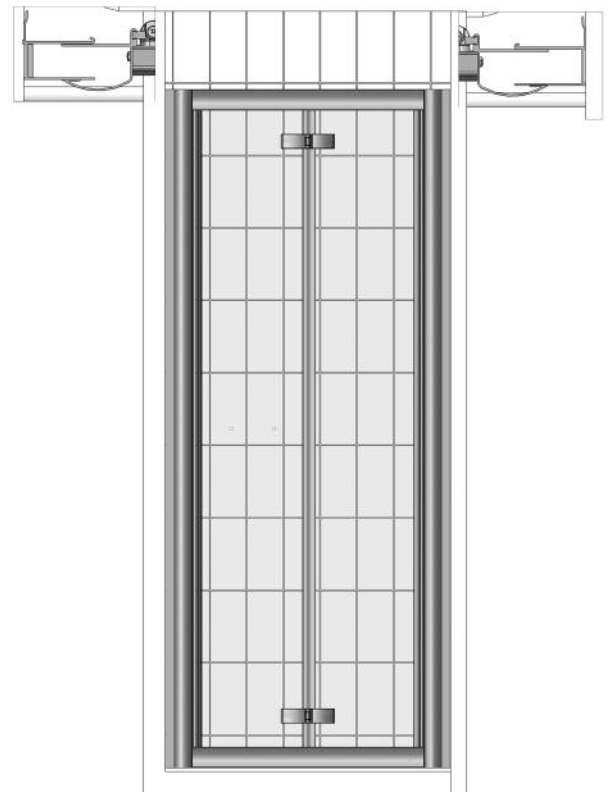

Move the door into the centre of the profiles.

Important: Check the door frame profiles are in the centre of the wall profiles. The frame profiles and wall profiles are going to be drilled and screwed together in the next steps.

Step 12 - Fix the door to the wall profiles

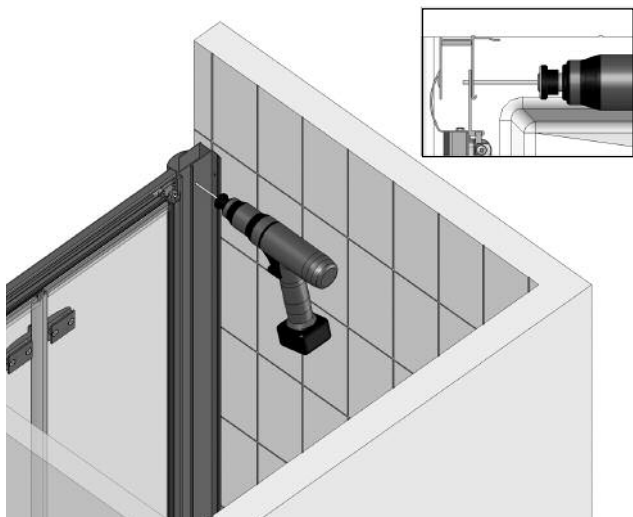

Move inside the enclosure and drill through the pre-drilled holes in the wall profile.

Step 13 - Fix the door to the wall profiles

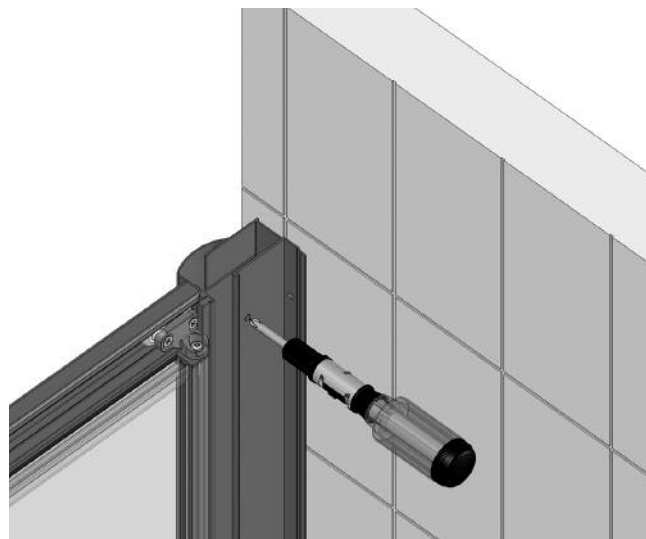

Fix the enclosure to the wall profiles using the supplied 16mm screws using a screw driver.

Step 14 - Check the installation

At this stage, check the installation of the enclosure is correct. You are about to check the operation of the door, this will be difficult if the installation is not correct at this point.

Perform the following checks:

Place a spirit level on the vertical extrusion at the top of the enclosure. If the spirit level bubble is in the centre of the two lines the enclosure is horizontally level.

Place a spirit level on the wall profiles one at a time. If the spirit level bubble is in the centre of the two lines the enclosure is vertically level.

If either the horizontal or vertical profiles are not level the door will not operate correctly.

Check the enclosure is sitting on the tray so there is an equal gap from the front of the enclosure to the tray.

If any or all of the above parameters are not correct - repeat all installation stages if necessary to achieve the correct configuration.

Step 15 - Assemble the handle

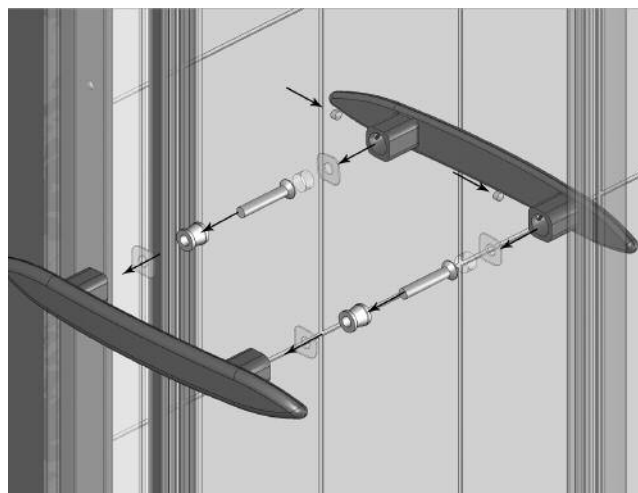

Remove the handle from the box and loosen off the two grub screws 2-3 turns to disassemble the handle.

The handle side **without** the grub screws has two threaded holes and is the front of the handle; it will be assembled on the outside of the enclosure.

Re-assemble the handle as shown above.

Important: there should be no metal touching the glass, the spacers must be used.

Step 16 - Adjusting the door

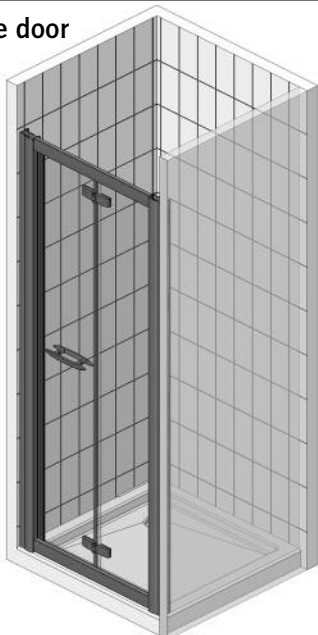

Try the operation of the door. If you are happy with the door please proceed to **Step 18**. If the door operation does not run smoothly please follow the instructions in **Step 17**.

Step 17 - Adjusting the door

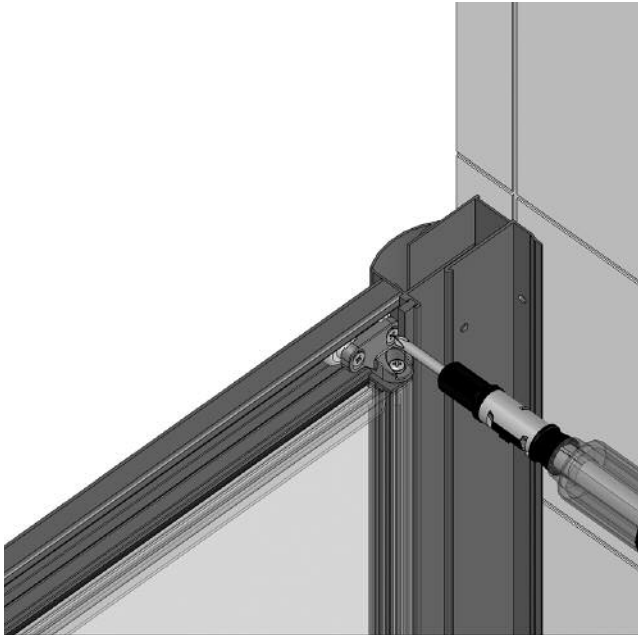

Look inside the enclosure. Locate the moving wheel assemblies. Loosen off the screws at the top and the bottom of the enclosure. When the screws are loose the door will be able to move up and down the slots in the wheels assemblies, simply lift or allow the door to move down the slots. When you are happy with the movement, tighten the screws back up using a screw driver.

TIP: Do not loosen the screws too much, 1 -3 turns will be sufficient. The screws will be tricky to re-tighten if they are loosened to much.

Step 18 - Fitting the wall profile trims

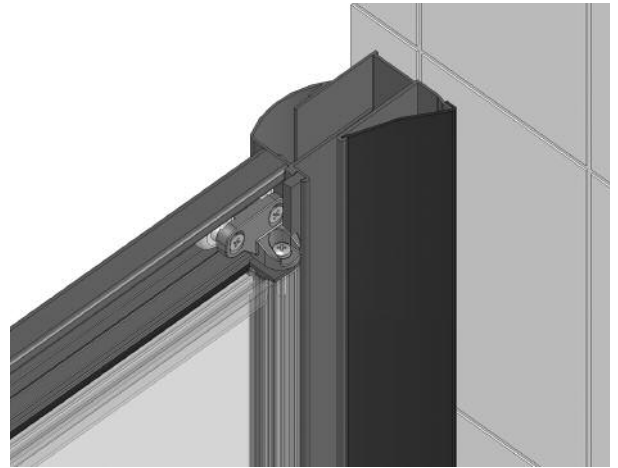

If you are happy with the installation push fit the trims on to the wall profiles, as shown above, the trims will clip into the profile. They are designed to be a tight fit so care must be taken when fitting.

Step 19 - Finishing off with the top caps and trims

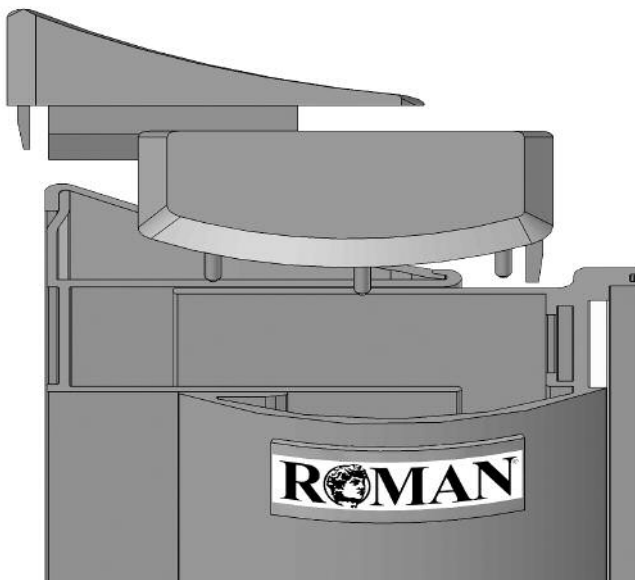

Push fit the profile caps on to the vertical profiles.

The caps are labelled left and right handed, on the inside of the moulding, step inside the enclosure to fit them.

Stick the self adhesive Roman Badge on the enclosure. (On a non moving part).

TIP: A drop of silicone can be used here to stick the profile caps on.

Step 20 - Seal the enclosure

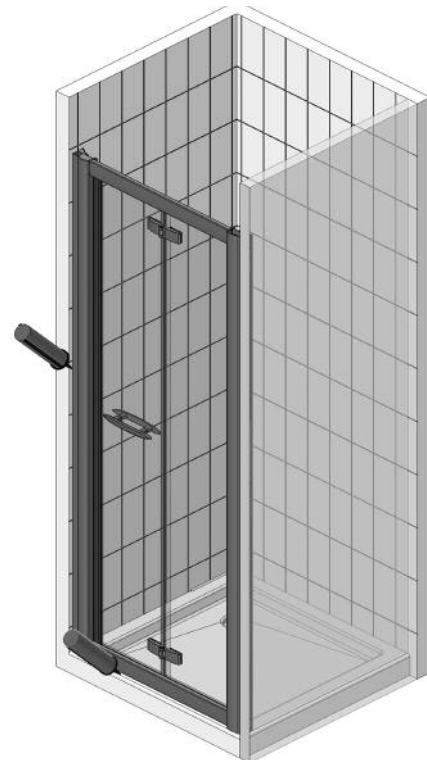

Using bathroom sealant (not supplied), seal along the full length of the wall profiles on the inside and outside of the enclosure.

Seal the enclosure horizontally along the full length of the bottom profile and the tray on the outside only.

Please leave the enclosure 24hrs for all the sealant to dry before use.

SPARE PARTS:

If you need to replace any damaged parts please see illustration below for parts list then call Customer Services on 01325 328034

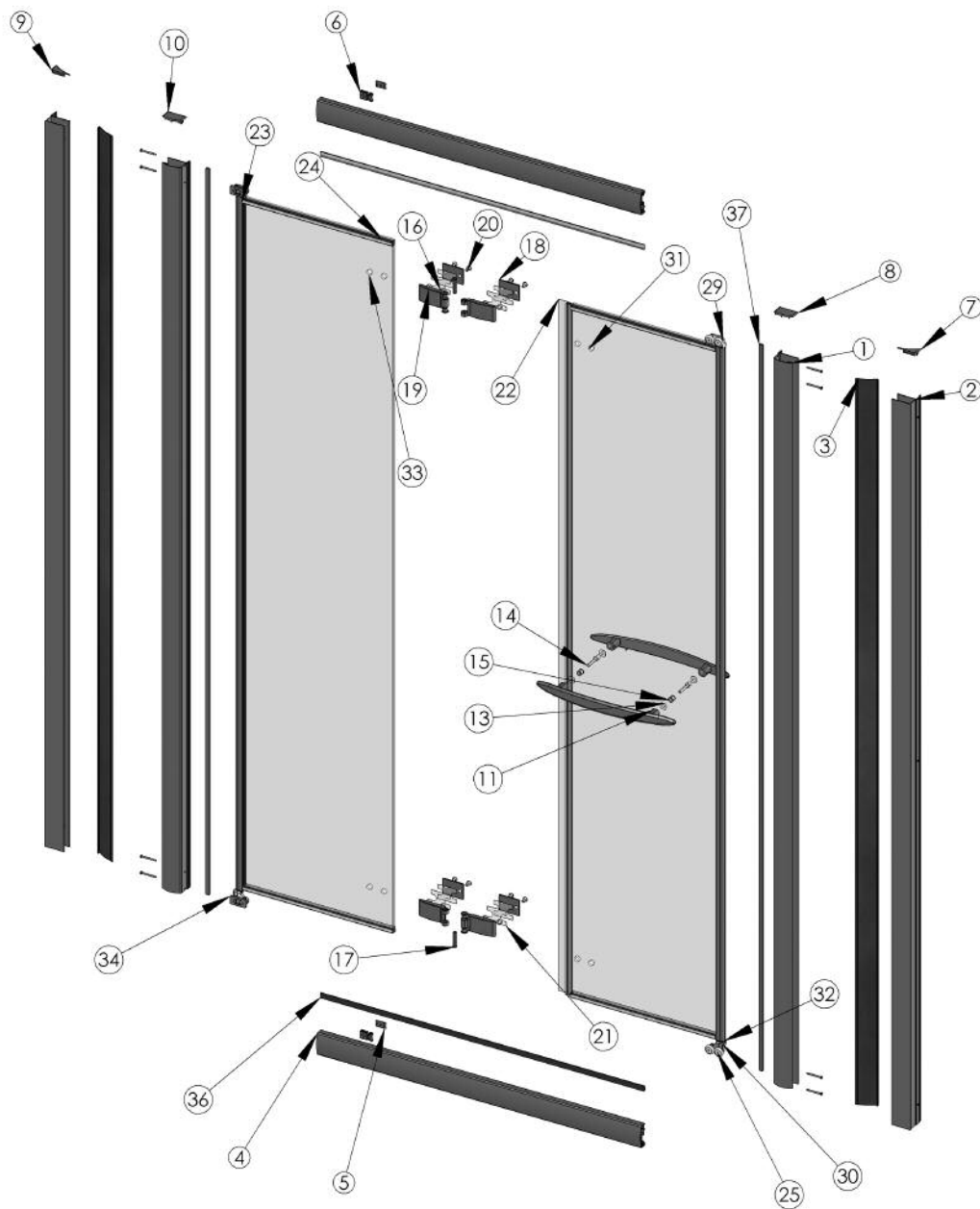

Should you experience any problems during installation please refer to the Trouble Shooting Guide (back page) or contact Roman Customer Services on:

01325 328034.

To enable Customer Services to provide you with an excellent level of service it is important that you quote your Product Code and Reference Number - these numbers can be found on the front of your Instruction Manual

TROUBLE SHOOTING GUIDE.

Problem	Solution
LEAKING	<ol style="list-style-type: none"> 1. Check the enclosure has been sealed correctly as the instructions. 2. Check the tray is sealed along the tiled walls prior to the installation. 3. The enclosure should not be sealed along the bottom horizontal extrusion on the inside of the enclosure. Sealing on the inside will cause a leak, please remove any silicone on the inside of this profile.
ENCLOSURE ALIGNMENT ON TRAY	<ol style="list-style-type: none"> 1. Check the wall profiles are fitted approximately 25mm from the front of the tray, 2. Check the wall profiles have been fitted vertically.
DOOR NOT RUNNING SMOOTHLY	<ol style="list-style-type: none"> 1. Check the door has been adjusted as the instructions, re-adjust as required. 2. Check the tray is completely level. 3. Check the hinges are level using a small spirit level. If not loosen the bolts 1-2 turns and carefully move the hinges one at a time until level then re-tighten the hinge bolts. (Be careful here - don't loosen the bolts right off as the hinges may fall off the product and damage the hinges and the glass. Two persons are recommended here.) 4. Check the wall profiles are fitted approximately 25mm from the front of the tray.
DOOR NOT CLOSING ONTO MAGNETS	<ol style="list-style-type: none"> 1. Remove the magnets and check the magnets attract each other, when attracting magnets are found; pair them up and re-assemble on the enclosure.

Some important information to help you Maintain your Roman product.

The following information is all you need to keep your Roman Product looking new. Roman Showering Products are designed for luxury showering and with care and attention you can keep them looking new for longer by using the strongly recommended Roman Ultra care. This is a multi-purpose glass protector that is applied after cleaning.(see back page for details). Alternatively you can clean your Roman Product using a mild detergent diluted in water and then polished off using a soft cloth. If you live in a hard water area, periodically clean your Roman product using a 50/50 solution of white vinegar and water. The solution should be left on the enclosure for approximately 5 minutes then rinsed off using warm water. This method of cleaning should remove lime scale residue.

Simple maintenance.

Roman Products are generally maintenance free, however it may be necessary to lubricate wheel assemblies and other moving parts from time to time. It is strongly recommended that a quality silicone spay is used.

A list of Don'ts:

- 1 - Don't use acidic based products which are unsuitable for cleaning enamel surfaces.
- 2 - Don't use Abrasive cleaners or cleaners containing bleach or solvents, these products will adversely affect the finish of the aluminium profiles.
- 3 - Don't use scouring pads, powder or any sharp instruments when cleaning the enclosure.



ULTRA CARE

THE MORE YOU SPRAY – THE MORE YOU PROTECT.

Roman Ultra Care is a product from Roman designed to give all your shower and bathroom surfaces a long-lasting sparkle. The benefit of Ultra Care is the more you spray, the more you protect.

Ultra Care is a multi-purpose glass protector that repels the build-up of grime, limescale and stains.

Roman Ultra Care was developed for Roman shower enclosures and screens. It is a unique and effective non-filming formula for all glass surfaces, tiles, shower seals and aluminium frames, taps, trays and baths.

Why not try it on your car windscreen!

For your nearest stockist please call +44 (0) 1325 328034

ROMAN LIMITED, WHITWORTH AVENUE, AYCLIFFE INDUSTRIAL PARK, COUNTY DURHAM, DL5 6YN, ENGLAND, UK.

Member of

GENERAL RECEPTION: PHONE +44 (0) 1325 311318 FAX +44 (0) 1325 319889

SALES OFFICE: PHONE +44 (0) 1325 328033 FAX +44 (0) 1325 328027

CUSTOMER SERVICE: PHONE +44 (0) 1325 328034 FAX +44 (0) 1325 328031



www.roman-showers.com