



# Orbital Sliding Door Enclosure

(1200 & 1400mm)

## Instruction Manual



### Truelife Consumer Guarantee

Please make sure the purchaser/end user completes and returns the Guarantee card which is enclosed with this product or registers on line at [www.roman-showers.com/register\\_guarantee.htm](http://www.roman-showers.com/register_guarantee.htm). Failure to validate the Roman Truelife Guarantee will mean only the 1 Year Statutory Guarantee will apply.

PRODUCT CODE REF:

### IMPORTANT

- Please ensure the consumer guarantee card enclosed with this product is completed and returned to Roman; please ensure the end user retains this manual.
- Please read these instructions carefully prior to attempting installation.
- Unpack and handle the product with care to avoid damage to the product finish.
- Check for hidden electrical cables and water pipes prior to commencing any drilling work.
- Do not plasterboard over the rim of the tray.
- Ensure the walls where the Enclosure is to be fitted are vertical. (If the walls are not completely vertical there is 25mm of adjustment in each Wall Profile.) *Note: It is recommended that the walls are tiled after the Tray is fitted and grouted before fitting the Enclosure. This will provide maximum adjustment and will aid sealing.*
- No attempt should be made to rework toughened safety glass.
- **Pictures used are for illustration purposes only, product designs may alter slightly as a result of continuing product development.**
- This is a two person installation.

### Component Check List: Supplied

Ref	Description	Quantities
A	Wall Profiles	2
B	Fixed Panel	1
C	Main Extrusion	1
D	Glass Door	1
E	Top Rail	1
F	Bottom Rail	1
G	Infill Trim	2
<b>Fitting Pack</b>		
H	40mm Screws	6
I	Wall Plugs	6
J	Left and Right Top Cap	1 of each
K	16mm Screws	6
L	3mm Drill Bit	1
M	9.5mm Counter Sunk Screws	6
N	Roman Branding Badge	1
O	Wall Profile Top Caps Left/Right	1 of each

### Equipment Checklist: Not Supplied

Electric Drill  
 6mm Masonry Drill Bit  
 Bathroom Sealant Gun  
 Bathroom Sealant Tube  
 Screwdriver  
 Spirit Level  
 Tape Measure  
 Pencil  
 Wall Plugs (Plasterboard)

### Before Assembly and Installation of the Orbital Sliding Door Enclosure

- Check to see that you have the correct handing Enclosure for your Tray. This can be done by referring to the label on the side of the product packaging.
- Ensure all parts are in the packaging by checking them against the parts and quantities shown on the component check list above.
- **Check the product for defects. Installation queries on damaged parts can not be resolved once the installation has been completed.**
- The Tray must be completely sealed along tiled walls, fitted level (check with a Spirit Level) and should have no leaks.

*Notes: It is recommended that the Wall Profiles are fitted directly onto tiles or a similar sealed surface. If walls or tray or a combination of both are out of level you will not achieve full adjustment of maximum width. Roman do not stipulate where the British Standard Safety Kite Mark should be positioned on the glass panels when being factory assembled.*

Prior to commencing the installation of your Orbital Slider Enclosure please ensure that the Enclosure is the correct handing as per your original requirement. Once the installation has commenced the installer becomes liable for any rectification costs due to incorrect specification of product at the point of order.



Figure a1

① Ensure the Tray is completely level, check for any movement in the Tray by standing in it. Fill the Tray with water to check all plumbing for leaks.

*Note: Please ensure the Tray is installed as per Manufacturer's Instructions. If the Tray is not completely level this will cause the Glass Door to hang incorrectly during its installation.*

## HOW TO ENSURE THE TRAY IS LEVEL

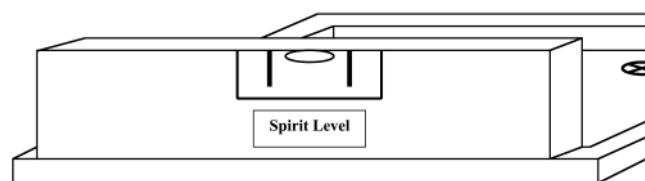

Figure a2

② Trays will only be completely level when the spirit level bubble is in the **centre** of the two lines visible shown above. **ALWAYS FOLLOW THIS PROCEDURE** (Figure a2)



Figure a3

③ Once tiling and grouting has been completed the Tray should be fully sealed with a Bathroom Sealant (not supplied) along the tiled walls prior to installation of the Enclosure. Prior to commencing installation of the Enclosure and once the Bathroom Sealant has cured, spray the shower handset around all joints to check for leaks.

*Note: It is important that the tiled walls are grouted prior to the installation of the Enclosure. Grout will cause discolouration of the aluminium parts.*

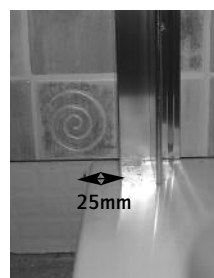

Figure a4



Figure a4i

④ Fit both Wall Profiles approx. 25mm from the front outside edge of the Tray (Figure a4). Ensure both Wall Profiles are completely vertical using a Spirit Level. Mark the slots with a pencil where the Wall Profiles are to be positioned (Figure a4i).

*Note: If the Wall Profiles are not completely vertical this will cause the Glass Door to hang incorrectly during its installation. The lip of the wall profile should face in towards your shower.*

## HOW TO ENSURE THAT WALL PROFILES ARE COMPLETELY VERTICAL

Figure a5

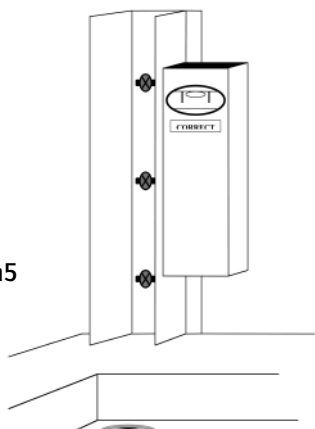

⑤ Wall Profiles will only be completely vertical when the spirit level bubble is in the **centre** of the two lines as shown (Figure a5). **ALWAYS FOLLOW THIS PROCEDURE.**



Figure a6

⑥ Drill the wall with a 6mm Masonry Drill Bit (not supplied) where the Wall Profiles (A) are to be positioned (Figure a6). Fit the Wall Plugs (I) (if going into a brick or block wall). If going into a plasterboard wall you will need to purchase appropriate wall fixings. Wipe clear all debris from the Tray before referring to the next stage.



Figure a7

Figure a7i

Figure a7ii

⑦ **IMPORTANT:** Where both Wall Profiles (A) are to be positioned onto the Tray place a bead of Bathroom Sealant (not supplied) the width of the Wall Profile along the tiled wall (Figure a7/a7i). Screw fix one Wall Profile where the fixed Panel (B) will be positioned onto the tray using the 40mm screws (H) (Figure A7ii).

*Note: If the Wall Profiles are not completely vertical this will cause the Glass Door to hang incorrectly during its installation. Failure to carry out Figure a7/a7i can cause serious water damage and is not covered by the guarantee.*

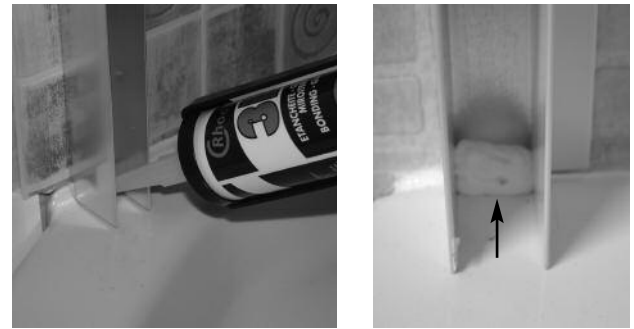

Figure a8

Figure a8i

⑧ Seal the inside gap between the base of the Wall Profile (A) to the Tray Top with a Bathroom Sealant (not supplied) (Figure a8/a8i).

*Note: Failure to carryout this procedure correctly can result in serious water damage and is not covered by the Guarantee.*

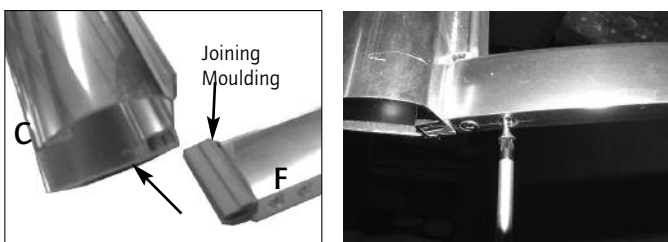

Figure a9

Figure a9i

⑨ Lift the main profile and slide the injection moulding and the bottom rail into the bottom of the main profile, as shown above (Figure a9). Once the Bottom Rail is in position, using the 9.5mm Counter Sunk Screws (M) screw fix the Bottom Rail through the pre-drilled holes into the Joining Moulding (Figure a9i). Ensure all screws are fully tightened

*Note: Ensure the Bottom Rail is pushed tight up against the Main Extrusion. You will need the help of an assistant.*

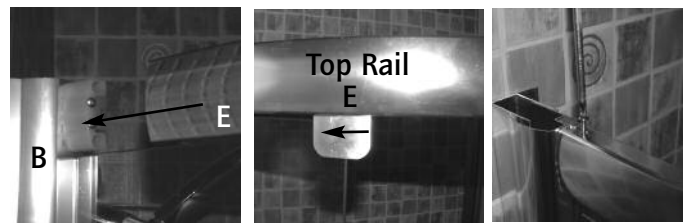

Figure a10

Figure a10i

Figure a10ii

⑩ Push the Top Rail (E) over the top of the Joining Moulding attached to the Fixed Panel (B) then repeat the same process for the Main Extrusion (C) (Figure a10). Please ensure the upper clamp on the Top Rail is located onto the end of the glass of the Fixed Panel (Figure a10i). Once the Top Rail is in position, using the 9.5mm Counter Sunk Screws (M) screw fix the Top Rail through the predrilled holes into the Joining Mouldings (Figure a10i). Ensure all Screws are fully tightened.

*Note: Ensure the Top Rail is pushed tight up against both Panels. You will need the help of an assistant.*



Figure a11

Figure a11i

Figure a11ii

⑪ Slide the Finishing Moulding off the Bottom Rail (F) (Figure a11). Take the Bottom Rail and position into the hole at the bottom of the Fixed Panel (B) (Figure a11i). Once the Bottom Rail is in position slide the Finishing Moulding down over the top of the Bottom Rail (Figure a11ii). To enable you to slide the Finishing Moulding down over the top of the Bottom Rail you will need to pull the vertical seal slightly off the end of the Fixed Panel.

*Note: You will need the help of an assistant.*

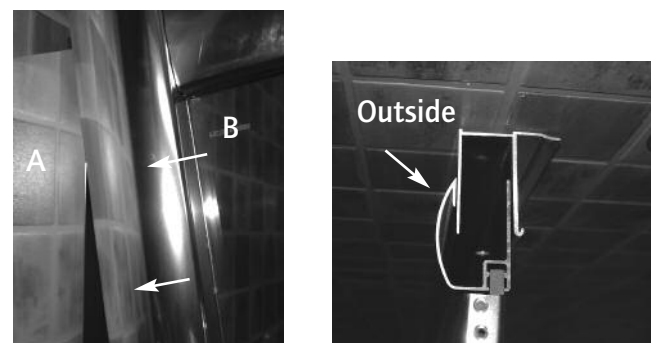

Figure a12

Figure a12i

⑫ Slide the remaining Wall Profile (A) over the Main Extrusion (C) and then slide the Fixed Panel (B) into the fitted Wall Profile (Figure a12). Ensure the Fixed Panel is positioned over the Wall Profile as shown in Figure a12i.

*Note: You will need the help of an assistant.*

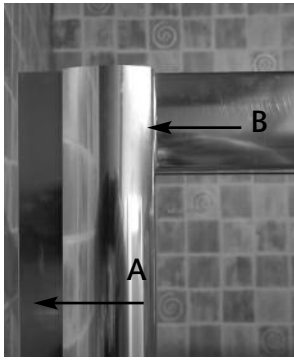

Figure a13

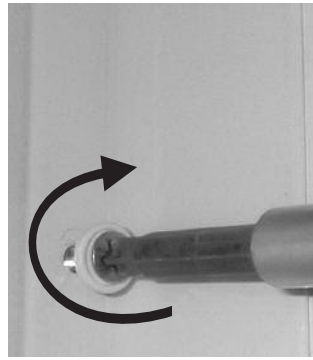

Figure a13i

- ⑬ Adjust the loose Wall Profile (A) so that it matches the holes drilled in the wall (Figure a13i), screw fix the Wall Profile to the wall using the 40mm Screws (H).

*Note: Ensure the enclosure is completely vertical and an equal gap has been achieved all around the outside of the Tray.*

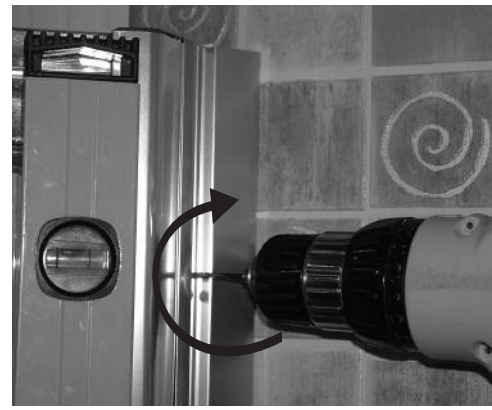

Figure a14

- ⑭ Once the Enclosure is completely vertical and an equal gap has been achieved around the outside of the Tray (Stage 13) move inside the Enclosure and drill three holes through both Wall Profiles (A) into the Fixed Panel (B) and the Main Extrusion (C) with a 3mm Drill Bit (L) (Figure a14). The three holes should be drilled 100mm approx. from the top, 100mm approx. from the bottom and one in the centre. The Large Panel and the Main Extrusion must remain completely vertical throughout this procedure.

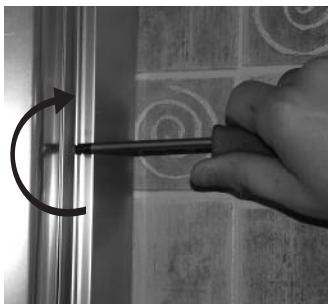

Figure a15

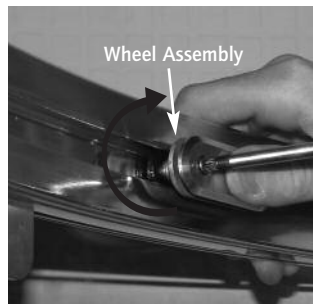

Figure a15i

- ⑮ Screw fix the 16mm Screws (K) into the holes that were drilled in Stage 14 with a Screwdriver (not supplied) (Figure a15). Inside the Enclosure take the Screws out of both Wheel Assemblies and remove the Brackets that are situated in the Top Rail (E) (Figure a15i). Place the Screws and Brackets in a safe place as you will require these in Stage 17.

- ⑯ Remove the Bottom Rail (F) from the Fixed Panel (B) that was installed in Stage 11, this can be done by reversing the procedure in Stage 11.

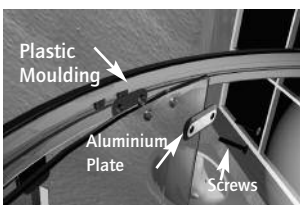

Figure a17



Figure a17i

- ⑰ Lift the Glass Door (D) to the required height. Push the Screws which were removed in Stage 15 through the Aluminium Plate then push the Screws through the two holes in the Glass Door and then into the Plastic Moulding (Figure a17). Align the two Screws with the Wheels in the Top Rail (E). Once the Screws are aligned apply pressure on the inside of the Glass Door and to the outside of the Top Rail and tighten the two Screws into the Wheels using a Screwdriver (not supplied) (Figure a17i). Repeat the same procedure to fit the remaining Wheel Assembly.

*Note: To fit the Glass Door you will require the help of an assistant.*



Figure a18



Figure a18i



Figure a18ii

- ⑱ Take the Bottom Rail (F) and position over the top of the Door Guide that is already fixed to the bottom of the Glass Door (D) (Figure a18). Please ensure the Bottom Rail is located correctly over the Door Guide (Figure a18i).

*Note: Ensure the Glass Door is located into the Static Guide correctly (Figure a18ii), to achieve this lift the Glass Door over the top of the Static Guide.*



Figure a19

Figure a19i

Figure a19ii

⑲ Once the Bottom Rail (F) is over the Door Guide and the Glass Door (C) is lifted over the Static Guide, position the end of the Bottom Rail into the holes at the bottom of the Fixed Panel (B) (Figure a19). Once the Bottom Rail is in position slide the Finishing Moulding back over the top of the Bottom Rail (Figure a19i).

*Note: Prior to sliding the Finishing Moulding down over the top of the Bottom Rail, please follow the sealing process illustrated (Figure A19ii).*

### Aerial View

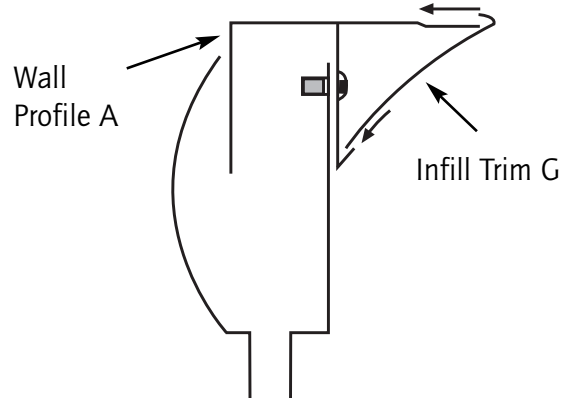

Figure a20

⑳ Once completely satisfied with your installation push fit the Infill Trims (G) into the vertical grooves of the Wall Profiles (A) (Figure a20). This will cover the Screws that were screw fixed in Stage 15.

*Note: The infill trim is designed to be a tight fit.*



Figure a21



Figure a21i

㉑ Take the correct handing Top Cap (J) and push down into the Fixed Panel's extrusion (B) and the Main Extrusion (C) (Figure a21/a21i). Then take the correct handing Wall Profile Top Caps (O) and push them down into the Wall Profile.



Figure a22



Figure a22i

㉒ Using a Bathroom Sealant (not supplied) seal both sides of the Wall Profiles (A) vertically to the inside and outside of the Enclosure where they meet the tiles only (Figure a22/a22i). Then fully seal the Enclosure along the Tray top from the outside only (Figure a22). Please allow 24 hours for the Bathroom Sealant to cure prior to using the Enclosure.

*Note: At no stage should you seal the Enclosure along the Tray top on the inside as this is a self draining unit. Failure to comply will result in the Enclosure leaking and is not covered by the Guarantee.*



Figure a23

### Figure a23

㉓ Ensure the Roman Branding Badge (N) is positioned on a non moving aluminium part to complete your installation.

## Maintaining Your Enclosure

**DO NOT** use acidic based descaler products or products which are unsuitable for cleaning enamel surfaces, including abrasive cleaners or cleaners containing bleach or solvents, as these products will affect both the anodised and coated framework.

**NEVER** use scouring powder or pads or sharp instruments when cleaning the enclosure.

Roman Shower Enclosures and Bath Screens are designed for luxury showering and with care and attention you can keep them looking new for longer by using the strongly recommended **Roman Ultra Care**, the multi-purpose glass protector after cleaning (See back page for details). Alternatively, occasionally wipe your Roman Shower Enclosure with a mild detergent diluted with water and polish with a soft cloth. If you live in a hard water area, periodically clean with a 50/50 solution of white vinegar and soak for five minutes and remove any limescale residue by rinsing with warm water. Periodically clean the seals of your Enclosure with an anti-bacterial spray. This is all you require to keep the glass, seals and coated / anodised aluminium parts looking new.

Should you experience any problems during installation please refer to your Instruction Manual Trouble Shooter Guide or alternatively please contact Roman Customer Services on: **01325 328034**.

To enable Customer Services to provide you with an excellent level of service it is important that you quote your Product Code and Reference Number - these numbers can be found on the front of your Instruction Manual

## Trouble Shooter Guide

Problem		Solution
Leaking	①	Check that the inside gap between the Tray and Wall Profiles has been sealed correctly (Figure a8/a8i).
	②	Ensure the Tray is sealed along the tiled walls prior to installation (Figure a3)
	③	If the inside joint between the Enclosure and The Tray top is sealed, this will cause leakage – the sealant must be removed.
	④	Ensure the Wall Profiles on the tiled walls are sealed both vertically inside and outside (Figure a22/a22i).
	⑤	Ensure the outside joint between the Enclosure and Tray top is sealed (Figure a22).
	⑥	Ensure the Bottom Rail was sealed correctly before sliding the finishing moulds on (Figure a19ii).
Enclosure alignment on Tray	①	Is the Enclosure fitted onto a tiled wall?
	②	Are the Wall Profiles fitted approx. 25mm in from the front outside edge of the Tray?
	③	Are the Wall Profiles completely vertical? (Figure a5)
Door not running smoothly	①	Ensure both Wall Profiles are completely vertical. (Figure a5)
	②	Ensure the Tray is completely level. (Figure a2)
	③	Ensure the Enclosure has an equal gap around the Tray Stages 13-14.
Door alignment	①	Ensure both Wall Profiles are completely vertical. (Figure a5)
	②	Ensure the Tray is completely level. (Figure a2)
	③	If the door is not aligned correctly, you have some adjustment in both Wheel Assemblies.



## ULTRA CARE

THE MORE YOU SPRAY – THE MORE YOU PROTECT.

Roman Ultra Care is a product from Roman designed to give all your shower and bathroom surfaces a long-lasting sparkle. The benefit of Ultra Care is the more you spray, the more you protect.

Ultra Care is a multi-purpose glass protector that repels the build-up of grime, limescale and stains.

Roman Ultra Care was developed for Roman shower enclosures and screens. It is a unique and effective non-filming formula for all glass surfaces, tiles, shower seals and aluminium frames, taps, trays and baths.

*Why not try it on your car windscreen!*

For your nearest stockist please call +44 (0) 1325 328034

ROMAN LIMITED, WHITWORTH AVENUE, AYCLIFFE INDUSTRIAL PARK, COUNTY DURHAM, DL5 6YN, ENGLAND, UK.

Member of

GENERAL RECEPTION: PHONE +44 (0) 1325 311318 FAX +44 (0) 1325 319889  
 SALES OFFICE: PHONE +44 (0) 1325 328033 FAX +44 (0) 1325 328027  
 CUSTOMER SERVICE: PHONE +44 (0) 1325 328034 FAX +44 (0) 1325 328031

www.roman-showers.com

